

# Treadwell & Rollo

2 May 2006  
Project No. 3157.04

Mr. Steve Patterson  
Millennium Partners  
753 Market Street, 3<sup>rd</sup> Floor  
San Francisco, California 94103

Subject: Summary of Pile Driving  
301 Mission Street  
San Francisco, California

Dear Mr. Patterson:

This letter summarizes our geotechnical observations of pile driving for the 301 Mission Street project in San Francisco. We previously performed a geotechnical investigation and provided the results in our report dated 13 January 2005 for the project and issued a letter and memorandum dated 23 November 2005 and 24 February 2006, respectively that summarized indicator pile driving and provided general pile driving criteria, including recommendations for production pile lengths and driving. We also issued a memorandum dated 6 April 2005 which discussed our recommendations regarding the sequencing of existing wood pile removal and concrete pile installation. In addition, we also provided the project with pile specifications dated 8 February 2005.

## BACKGROUND

Project plans include constructing a 60-story tower comprised of residential and retail space, a nine-story structure with residential and retail space, and a three-story-high atrium and lobby. The tower portion of the site will have one basement level, while the nine-story building and atrium will have five levels of underground parking. We recommended the tower structure be supported on a pile foundation system with the other portions on a mat foundation, as discussed in the geotechnical report.

Subsurface conditions at the site consist of heterogeneous fill over Marine Deposits underlain by clayey sand with interbedded layers of sandy clay, and Old Bay Clay to the maximum explored depth of about 220 feet below the street elevation. The geotechnical report and pile specifications recommended that the 14-inch square precast-prestressed concrete piles be driven into a dense to very dense sand layer beneath the site. The top of this bearing layer varies from

Mr. Steve Patterson  
Millennium Partners  
2 May 2006  
Page 2

66 to 91 feet below the street level. This corresponds to approximately Elevation -62 to -87 feet<sup>1</sup> San Francisco City Datum. The allowable dead plus live load is 260 kips per pile.

The general contractor for the project is Webcor Builders Inc. (WBI) of San Mateo, California and the pile driving contractor is American Piledriving Inc. (API) of Pleasanton, California. Project foundation plans were prepared by DeSimone Consulting Engineers (DCE) and are dated 8 January 2005.

## INDICATOR PILE PROGRAM

Twenty five indicator piles were driven at the site during 2 phases between 27 October 2005 and 4 November 2005 and on 23 February 2006. Our engineer was on site to observe the pile driving operation on a continuous basis, and pile driving records showing resistance to penetration versus depth were maintained for each pile.

The locations of the indicator piles, designated by Treadwell & Rollo, Inc. (T&R) as I-1 through I-25, are shown on Figure 1. All of the indicator piles are 14-inch-square, prestressed, precast concrete piles with total lengths of varying from 67 to 83 feet. A summary of the indicator pile data is presented on the first page of the attached Table 1.

During portions of the indicator pile program, InSituTech, Ltd. (InSituTech) performed Pile Driving Analyzer (PDA) tests on ten of the indicator piles. In addition to the PDAs, InSituTech also performed a Case Pile Wave Analysis Program (CAPWAP) on five of the ten PDA indicator piles to estimate ultimate pile capacities. Our 23 November 2005 letter presents the results of the analyses by InSituTech.

## PRODUCTION PILE PROGRAM

Production Piles were driven using two pile driving rigs both equipped with a Delmag D46-32 diesel hammers. This hammer has a maximum rated energy of 107,177 foot-pounds on Fuel Setting 4 (used for both indicator and production piles). To facilitate driving through the fill, pile locations were predrilled with a 14-inch diameter auger to an approximate depth of between 0 and 45 feet below the ground surface. Before driving, a 16-inch-thick plywood cushion block was placed on top of each pile. Since piles were being installed from a higher ground elevation relative to foundation subgrade, a specially fabricated steel follower was used to drive the piles below grade.

All piles are 14-inch square, precast, prestressed concrete piles with total lengths of between approximately 47 to 83 feet, with additional reinforcing steel in the top of the pile to allow for 12

<sup>1</sup> All elevations referenced in this letter are in feet relative to San Francisco City Datum, (SFCD).

# Treadwell & Rollo

Mr. Steve Patterson  
Millennium Partners  
2 May 2006  
Page 3

feet of cutoff. Piles were driven to their full length, except where they reached refusal prior to achieving the design tip elevation. A total of 80 piles were stopped above the 12-foot cutoff (see Table 1) which was reviewed and accepted by DCE. In addition, 9 piles broke during installation, which required the installation of 2 replacement piles (see Table 1 for more information).

The production piles were driven between 1 March and 22 April 2005. Our engineers were on site full-time to observe pile installation and record pile lengths, driving resistances, tip elevations, approximate cut-off lengths, and depth of predrilling. A total of 947 piles (25 indicator piles, 920 production piles and 2 replacement piles) were driven for the project. Driving records for each pile are retained in our files. A summary of the pile data including the blow counts for the last 5 feet of penetration is presented in Table 1, and locations of piles are shown on the accompanying foundation plan (Figure 1).

## CONCLUSIONS

On the basis of our observations during the pile driving and our engineering analyses, we conclude the piles for the 301 Mission Street project were installed in accordance with the intent of project plans and our recommendations and are capable of carrying the design loads presented in our geotechnical report.

We trust this letter presents the information required. If you have any questions, please call

Sincerely yours,  
TREADWELL & ROLLO, INC.

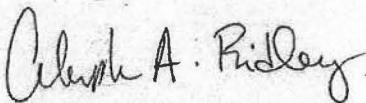

Christopher A. Ridley  
Geotechnical Engineer



Ramin Golesorkhi  
Geotechnical Engineer

31570409.CAR

Attachments: Figure 1 – Foundation Plan Showing Pile Numbering  
Table 1 – Indicator and Production Pile Summary

cc: Mr. Kurt Ricci – WEBCOR Builders (via E-mail)

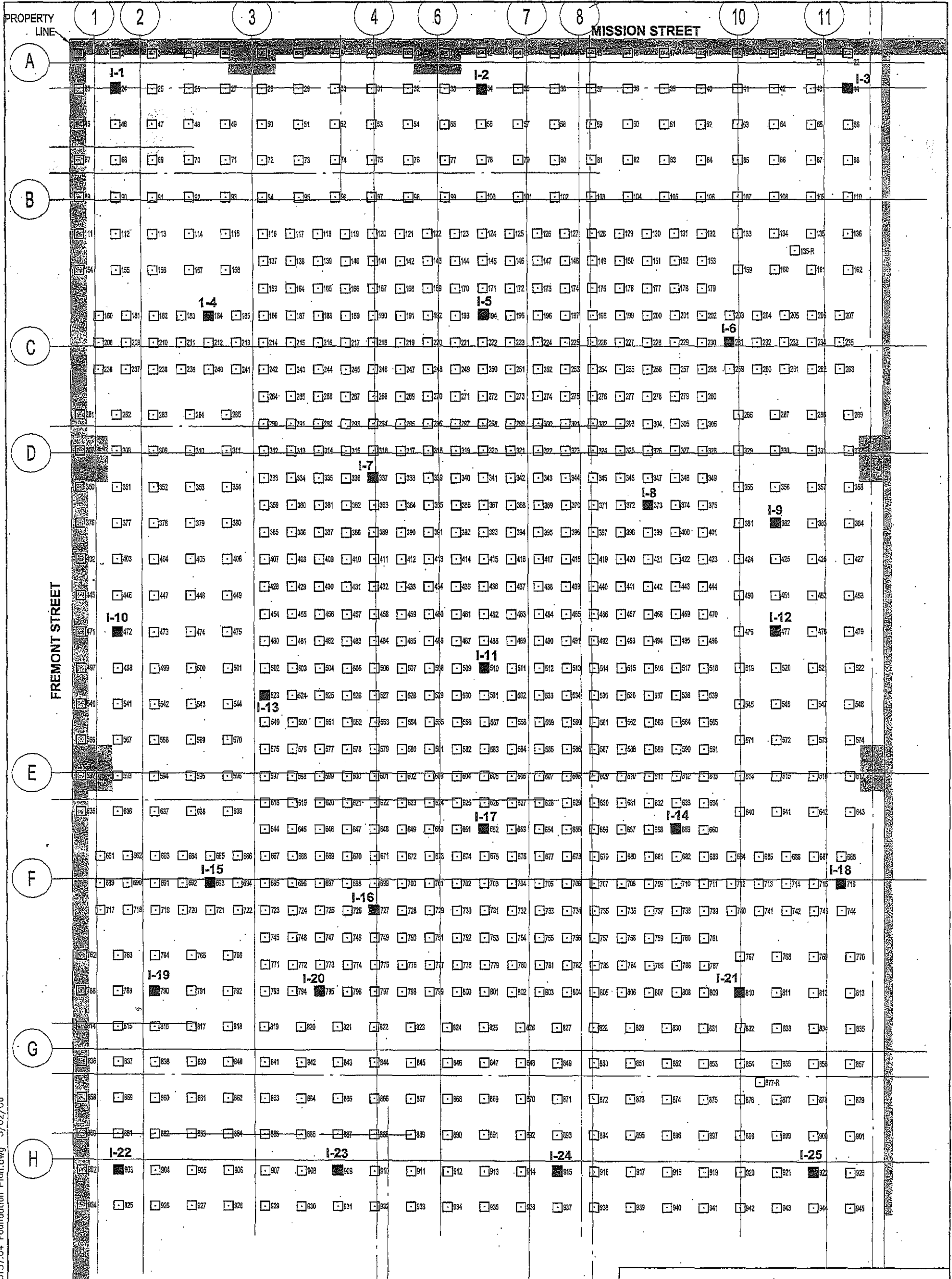

EXPLANATION

- Approximate location of production pile
- I-14**  Approximate location of indicator pile

Reference: "Level B-1 - West Plan" Sheet S2.0.B1.11, by Desimone Consulting Engineers, Dated 8 January 2005. Numbering system by Martin Ron Associates.

0 12 Feet  
Approximate scale

<b>301 MISSION STREET</b> San Francisco, California		
<b>FOUNDATION PLAN</b> <b>SHOWING PILE NUMBERING</b>		
Date 05/02/06	Project No. 3157.04	Figure 1
<b>Treadwell &amp; Rollo</b>		

TABLE 1  
Indicator and Production Pile Summary  
301 Mission Street  
San Francisco, California

Treadwell & Rolfe Pile No.	Project Pile Number <sup>1</sup>	Date Driven	Furnished Length (feet) <sup>2</sup>	Predrill Depth (feet)	Design Pile Cutoff Elevation (feet) <sup>3</sup>	Actual Top of Pile Elevation (feet) <sup>3,4</sup>	Approximate Tip Elevation (feet) <sup>3</sup>	Approximate Cut-off Length (feet)	Final Driving (Blows/foot for final 5 feet)					Remarks
									24	20	21	20	5-3"	
I-1	24	10/31/05	68	5	-21.90	-23.25	-91.3	-1.4	24	20	21	20	5-3"	PDA performed
I-2	34	10/31/05	67	5	-21.90	-24.00	-91.0	-2.1	24	19	18	19	15	PDA performed
I-3	44	10/31/05	67	5	-21.90	-26.50	-93.5	-4.6	24	31	27	24	21	PDA & CAPWAP performed
I-4	184	10/31/05	70	5	-21.90	DNO <sup>5</sup>	DNO <sup>5</sup>	DNO <sup>5</sup>						PDA performed, T&R did not observe the final 14 feet of driving
I-5	194	11/04/05	67	5	-21.90	-25.00	-92.0	-3.1	32	28	26	22	27	
I-6	231	10/31/05	67	5	-21.90	-26.00	-93.0	-4.1	62	76	80	32	24	PDA & CAPWAP performed
I-7	337	11/04/05	68	5	-21.90	-24.30	-92.3	-2.4	24	20	23	34	8-3"	
I-8	373	11/03/05	83	5	-21.90	-24.00	-107.0	-2.1	18	17	18	17	18	PDA & CAPWAP performed
I-9	382	11/02/05	67	10	-21.90	-25.30	-92.3	-3.4	30	19	22	24	8-3"	
I-10	472	11/03/05	70	5	-21.90	-13.80	-83.8	8.1	38	31	40	68	100-10"	
I-11	510	11/04/05	68	5	-32.90	-24.50	-92.5	8.4	69	38	40	32	14-6"	
I-12	477	10/28/05	67	20	-21.90	-21.70	-88.7	0.2	34	50	58	50	40-8"	
I-13	523	11/03/05	70	5	-21.90	-23.30	-93.3	-1.4	47	18	24	21	8-4"	PDA & CAPWAP performed
I-14	659	10/27/05	70	5	-21.90	-22.00	-92.0	-0.1	41	32	24	20	17	
I-15	693	11/03/05	78	5	-21.90	-5.50	-83.5	16.4	14	36	37	62	90-6"	
I-16	727	11/03/05	73	5	-21.90	-25.80	-98.3	-3.4	20	18	16	15	7-4"	
I-17	653	11/04/05	73	5	-21.90	-10.80	-83.8	11.1	9	15	42	72	95-10"	
I-18	716	11/03/05	68	5	-21.90	-17.80	-85.8	4.1	50	48	50	79	95-10"	PDA performed
I-19	790	10/27/05	82	5	-21.90	-20.00	-102.0	1.9	16	15	13	13	14	
I-20	795	11/03/05	80	5	-21.90	-2.80	-82.8	19.1	23	20	39	70	92-10"	PDA & CAPWAP performed
I-21	810	11/03/05	73	5	-21.90	-25.70	-98.7	-3.8	24	12	12	13	8-8"	PDA performed
I-22	903	02/22/06	78	20	-21.90	-22.00	-100.0	-0.1	15	24	16	11	12	
I-23	909	02/22/06	83	20	-21.90	-16.50	-99.5	5.4	17	13	11	12	6-6"	
I-24	915	02/22/06	75	20	-21.90	-22.00	-97.0	-0.1	22	17	17	16	15	
I-25	922	02/22/06	73	20	-21.90	-22.00	-95.0	-0.1	13	13	13	14	15	
1	13	03/01/06	50.1	15	-21.90	-21.90	-72.0	0.0	31	32	38	43	28-9"	
2	12	03/01/06	50.1	15	-21.90	-21.00	-71.1	0.9	18	26	34	30	72	
3	35	03/01/06	50.1	15	-21.90	-21.90	-72.0	0.0	23	36	34	33	20-5"	
4	56	03/01/06	50.1	15	-21.90	-21.90	-72.0	0.0	20	23	28	29	29	
5	57	03/01/06	50.1	15	-21.90	-21.90	-72.0	0.0	18	25	31	33	27	
6	1	03/01/06	50.1	5	-21.90	-21.90	-72.0	0.0	31	30	44	50	29-9"	
7	2	03/01/06	50.1	10	-21.90	-21.90	-72.0	0.0	13	20	33	44	49	
8	25	03/02/06	50.1	10	-21.90	-21.90	-72.0	0.0	22	30	40	48	23-6"	
9	3	03/02/06	50.1	10	-21.90	-21.00	-71.1	0.9	13	13	28	38	73	
10	350	03/02/06	56.1	10	-21.90	-21.90	-78.0	0.0	19	16	13	13	14	Final blowcount < 21 b/ft, capacity is 260 kips - see restrick of pile #393 (3/31/06)
11	351	03/02/06	56.1	10	-21.90	-21.90	-78.0	0.0	17	16	16	12	11	Final blowcount < 21 b/ft, capacity is 260 kips - see restrick of pile #393 (3/31/06)
12	352	03/02/06	56.1	10	-21.90	-21.90	-78.0	0.0	15	13	14	11	12	Final blowcount < 21 b/ft, capacity is 260 kips - see restrick of pile #393 (3/31/06)
13	307	03/02/06	56.1	10	-21.90	-21.90	-78.0	0.0	20	16	16	15	13	Final blowcount < 21 b/ft, capacity is 260 kips - see restrick of pile #393 (3/31/06)
14	308	03/02/06	56.1	10	-21.90	-21.90	-78.0	0.0	29	24	25	21	14	Final blowcount < 21 b/ft, capacity is 260 kips - see restrick of pile #393 (3/31/06)
15	309	03/02/06	56.1	10	-21.90	-21.90	-78.0	0.0	26	24	18	20	18	Final blowcount < 21 b/ft, capacity is 260 kips - see restrick of pile #393 (3/31/06)
16	689	03/02/06	61.1	10	-21.90	-21.90	-83.0	0.0	6	8	13	20	27	
17	635	03/02/06	61.1	10	-21.90	-21.90	-83.0	0.0	7	8	14	20	48	
18	661	03/02/06	61.1	10	-21.90	-21.90	-83.0	0.0	6	8	12	34	28-6"	
19	690	03/02/06	61.1	10	-21.90	-21.90	-83.0	0.0	7	8	9	26	28	

TABLE I  
Indicator and Production Pile Summary  
301 Mission Street  
San Francisco, California

Treadwell & Rollo Pile No.	Project Pile Number	Date Driven	Furnished Length (feet)	Pre-drill Depth (feet)	Design Pile Cutoff Elevation (feet) <sup>2</sup>	Actual Top of Pile Elevation (feet) <sup>3,4</sup>	Approximate Tip Elevation (feet) <sup>3</sup>	Approximate Cut-off Length (feet)	Final Driving (Blows/foot for final 5 feet)					Remarks
									7	7	9	10	22	
20	662	03/02/06	61.1	15	-21.90	-21.90	-83.0	0.0	7	7	9	10	22	
21	691	03/02/06	61.1	15	-21.90	-21.30	-82.4	0.6	9	9	11	23	57	
22	663	03/02/06	61.1	15	-21.90	-21.90	-83.0	0.0	8	12	18	49	25-6"	
23	636	03/02/06	61.1	15	-21.90	-21.90	-83.0	0.0	7	10	13	28	29	
24	637	03/02/06	61.1	15	-21.90	-21.90	-83.0	0.0	7	7	14	30	21-6"	
25	14	03/03/06	50.1	15	-21.90	-21.90	-72.0	0.0	17	27	34	32	20-6"	
26	15	03/03/06	50.1	15	-21.90	-21.90	-72.0	0.0	31	34	50	48	28-6"	
27	16	03/03/06	50.1	15	-21.90	-21.90	-72.0	0.0	26	39	46	42	47	
28	36	03/03/06	50.1	15	-21.90	-21.90	-72.0	0.0	18	30	34	46	19-6"	
29	37	03/03/06	50.1	15	-21.90	-21.90	-72.0	0.0	28	37	39	43	44	
30	38	03/03/06	50.1	15	-21.90	-21.90	-72.0	0.0	30	50	53	58	33-6"	
31	58	03/03/06	50.1	15	-21.90	-21.90	-72.0	0.0	20	32	36	34	18-6"	
32	59	03/03/06	50.1	15	-21.90	-21.90	-72.0	0.0	22	34	38	37	36	
33	60	03/03/06	50.1	15	-21.90	-20.90	-71.0	1.0	22	30	46	43	61	
34	17	03/03/06	50.1	15	-21.90	-21.90	-72.0	0.0	21	39	44	41	47	
35	39	03/03/06	50.1	15	-21.90	-19.90	-70.0	2.0	85	77	79	120	70-6"	
36	61	03/03/06	50.1	15	-21.90	-20.90	-71.0	1.0	27	33	52	52	63	
37	18	03/03/06	50.1	15	-21.90	-21.90	-72.0	0.0	45	34	57	53	13-3"	
38	40	03/03/06	50.1	15	-21.90	-19.90	-70.0	2.0	42	29	44	60	40-6"	
39	592	03/03/06	61.1	10	-21.90	-21.90	-83.0	0.0	11	12	11	17	32	
40	566	03/03/06	61.1	10	-21.90	-21.90	-83.0	0.0	10	10	11	15	30	
41	540	03/03/06	61.1	10	-21.90	-21.90	-83.0	0.0	6	7	9	12	29	
42	497	03/03/06	61.1	10	-21.90	-21.90	-83.0	0.0	7	9	10	27	36	
43	471	03/03/06	61.1	10	-21.90	-21.90	-83.0	0.0	7	8	11	14	40	
44	445	03/03/06	61.1	10	-21.90	-21.90	-83.0	0.0	6	7	7	9	24	
45	593	03/03/06	61.1	10	-21.90	-21.90	-83.0	0.0	10	13	18	31	66	
46	567	03/03/06	61.1	10	-21.90	-21.90	-83.0	0.0	7	9	10	22	40	
47	541	03/03/06	61.1	10	-21.90	-21.90	-83.0	0.0	8	9	16	28	66	
48	498	03/03/06	61.1	10	-21.90	-21.90	-83.0	0.0	9	9	11	16	46	
49	446	03/04/06	61.1	10	-21.90	-21.90	-83.0	0.0	8	8	11	22	36	
50	447	03/04/06	61.1	10	-21.90	-21.90	-83.0	0.0	8	6	7	15	32	
51	473	03/04/06	61.1	10	-21.90	-21.90	-83.0	0.0	8	8	9	13	51	
52	499	03/04/06	61.1	10	-21.90	-21.90	-83.0	0.0	8	9	10	31	60	
53	542	03/04/06	61.1	10	-21.90	-21.90	-83.0	0.0	7	11	12	35	58	
54	568	03/04/06	61.1	10	-21.90	-21.90	-83.0	0.0	9	9	18	33	38	
55	594	03/04/06	61.1	10	-21.90	-21.90	-83.0	0.0	9	10	17	30	34	
56	717	03/04/06	61.1	10	-21.90	-21.90	-83.0	0.0	5	7	16	30	36	
57	762	03/04/06	61.1	10	-21.90	-21.90	-83.0	0.0	6	10	19	31	44	
58	788	03/04/06	61.1	10	-21.90	-21.90	-83.0	0.0	7	7	14	30	54	
59	789	03/04/06	61.1	10	-21.90	-21.90	-83.0	0.0	6	8	20	35	50	
60	763	03/04/06	61.1	10	-21.90	-21.90	-83.0	0.0	8	8	13	26	48	
61	718	03/04/06	61.1	10	-21.90	-21.90	-83.0	0.0	6	8	16	34	49	
62	764	03/04/06	61.1	10	-21.90	-21.90	-83.0	0.0	7	7	15	30	51	
63	719	03/04/06	61.1	10	-21.90	-21.90	-83.0	0.0	7	10	21	37	50	

TABLE 1  
Indicator and Production Pile Summary  
301 Mission Street  
San Francisco, California

Breadwell & Rollo Pile No.	Project File Number	Date Driven	Furnished Length (feet) <sup>2</sup>	Predrill Depth (feet)	Design File Cutoff Elevation (feet) <sup>3</sup>	Actual Top of Pile Elevation (feet) <sup>4*</sup>	Approximate Tip Elevation (feet) <sup>3</sup>	Approximate Cut-off Length (feet)	Final Driving (Blows/foot for final 5 feet) <sup>5</sup>					Remarks
									45	28	49	68	35-6"	
64	62	03/04/06	50.1	15	-21.90	-19.90	-70.0	2.0	45	28	49	68	35-6"	
65	4	03/04/06	50.1	15	-21.90	-21.90	-72.0	0.0	27	28	31	36	35	
66	5	03/04/06	50.1	15	-21.90	-21.90	-72.0	0.0	22	22	25	27	28	
67	6	03/04/06	50.1	15	-21.90	-21.90	-72.0	0.0	22	26	29	23	18-9"	
68	7	03/04/06	50.1	15	-21.90	-21.90	-72.0	0.0	21	25	30	30	27	
69	8	03/04/06	50.1	15	-21.90	-21.90	-72.0	0.0	21	29	26	29	26	
70	9	03/04/06	50.1	15	-21.90	-21.90	-72.0	0.0	25	29	24	30	26	
71	10	03/04/06	50.1	15	-21.90	-21.90	-72.0	0.0	17	26	30	34	32	
72	11	03/04/06	50.1	15	-21.90	-19.40	-69.5	2.5	27	24	39	61	32-6"	
73	26	03/04/06	50.1	15	-21.90	-21.90	-72.0	0.0	21	34	40	41	19-6"	
74	48	03/04/06	50.1	15	-21.90	-21.90	-72.0	0.0	19	26	33	31	14-6"	
75	27	03/04/06	50.1	15	-21.90	-21.90	-72.0	0.0	20	31	41	44	21-6"	
76	49	03/04/06	50.1	15	-21.90	-21.90	-72.0	0.0	14	26	38	40	44	
77	28	03/04/06	50.1	15	-21.90	-21.90	-72.0	0.0	32	39	41	32	18-6"	
78	50	03/04/06	50.1	15	-21.90	-21.90	-72.0	0.0	14	29	36	38	24-6"	
79	29	03/04/06	50.1	15	-21.90	-21.90	-72.0	0.0	30	41	46	44	32	
80	51	03/04/06	50.1	15	-21.90	-21.90	-72.0	0.0	15	31	37	37	36	
81	30	03/04/06	50.1	15	-21.90	-21.90	-72.0	0.0	30	50	45	39	17-6"	
82	52	03/06/06	50.1	15	-21.90	-21.90	-72.0	0.0	25	34	32	35	33	
83	31	03/06/06	50.1	15	-21.90	-21.90	-72.0	0.0	20	30	37	35	32	
84	32	03/06/06	50.1	15	-21.90	-21.90	-72.0	0.0	38	39	35	41	15-6"	
85	33	03/06/06	50.1	15	-21.90	-21.90	-72.0	0.0	28	40	38	40	40	
86	53	03/06/06	50.1	15	-21.90	-21.90	-72.0	0.0	23	32	31	32	15-6"	
87	54	03/06/06	50.1	15	-21.90	-21.90	-72.0	0.0	16	29	35	36	36	
88	55	03/06/06	50.1	15	-21.90	-21.90	-72.0	0.0	31	44	57	39	20-6"	
89	19	03/06/06	50.1	15	-21.90	-21.90	-72.0	0.0	30	39	35	35	42	
90	20	03/06/06	50.1	15	-21.90	-21.90	-72.0	0.0	31	39	45	44	47	
91	402	03/06/06	61.1	10	-21.90	-21.90	-83.0	0.0	9	9	13	30	3-1"	Final blowcount < 21 b/ft, capacity is 260 kips - see restrike of pile #393 (3/31/06)
92	376	03/06/06	61.1	10	-21.90	-21.90	-83.0	0.0	8	7	9	13	15-9"	Final blowcount < 21 b/ft, capacity is 260 kips - see restrike of pile #393 (3/31/06)
93	377	03/06/06	61.1	10	-21.90	-21.90	-83.0	0.0	11	10	10	14	21	
94	403	03/06/06	61.1	10	-21.90	-21.90	-83.0	0.0	13	11	11	25	18-6"	
95	378	03/06/06	61.1	10	-21.90	-21.90	-83.0	0.0	10	10	9	10	14	Final blowcount < 21 b/ft, capacity is 260 kips - see restrike of pile #393 (3/31/06)
96	404	03/06/06	61.1	10	-21.90	-21.90	-83.0	0.0	11	9	10	22	13-5"	
97	924	03/06/06	61.1	10	-21.90	-21.90	-83.0	0.0	7	9	17	22	13-6"	
98	902	03/06/06	61.1	10	-21.90	-21.90	-83.0	0.0	11	12	17	26	11-5"	
99	880	03/06/06	61.1	10	-21.90	-21.90	-83.0	0.0	11	9	15	18	4-1"	
100	858	03/06/06	61.1	10	-21.90	-21.90	-83.0	0.0	8	10	7	10	10-6"	Final blowcount < 21 b/ft, capacity is 260 kips - see restrike of pile #393 (3/31/06)
101	836	03/06/06	61.1	10	-21.90	-21.90	-83.0	0.0	7	9	7	11	15-11"	Final blowcount < 21 b/ft, capacity is 260 kips - see restrike of pile #393 (3/31/06)
102	814	03/06/06	61.1	10	-21.90	-21.90	-83.0	0.0	6	6	6	10	18-9"	
103	925	03/06/06	61.1	10	-21.90	-21.90	-83.0	0.0	7	7	17	26	5-1"	
104	926	03/06/06	61.1	10	-21.90	-21.90	-83.0	0.0	10	8	10	25	13-6"	
105	904	03/06/06	61.1	10	-21.90	-21.90	-83.0	0.0	12	12	12	18	13-5"	
106	881	03/06/06	61.1	10	-21.90	-21.90	-83.0	0.0	10	12	9	13	20-10"	
107	882	03/06/06	61.1	10	-21.90	-21.90	-83.0	0.0	11	13	14	33	29-6"	

TABLE 1  
Indicator and Production Pile Summary  
301 Mission Street  
San Francisco, California

Treadwell & Rollo Pile No.	Project Pile Number <sup>1</sup>	Date Driven	Furnished Length (feet) <sup>2</sup>	Pre-drill Depth (feet)	Design Pile Cutoff Elevation (feet) <sup>3</sup>	Actual Top of Pile Elevation (feet) <sup>3,4</sup>	Approximate Tip Elevation (feet) <sup>5</sup>	Approximate Cut-off Length (feet) <sup>6</sup>	Final Driving (Blows/foot for final 5 feet)					Remarks
108	859	03/06/06	61.1	10	-21.90	-21.90	-83.0	0.0	13	8	10	16	7-3"	
109	21	03/07/06	50.1	15	-21.90	-20.90	-71.0	1.0	24	26	39	41	62	
110	22	03/07/06	50.1	15	-21.90	-19.90	-70.0	2.0	26	34	47	80	37-6"	
111	43	03/07/06	50.1	15	-21.90	-19.90	-70.0	2.0	44	34	47	63	67	
112	42	03/07/06	50.1	15	-21.90	-20.40	-70.5	1.5	28	31	43	50	70-6"	
113	41	03/07/06	50.1	15	-21.90	-19.90	-70.0	2.0	32	41	58	66	25-3"	
114	63	03/07/06	50.1	15	-21.90	-19.90	-70.0	2.0	55	42	51	74	90	
115	64	03/07/06	50.1	15	-21.90	-19.90	-70.0	2.0	42	56	86	117	31-3"	
116	65	03/07/06	50.1	15	-21.90	-20.90	-71.0	1.0	27	40	46	64	63	
117	66	03/07/06	50.1	15	-21.90	-19.90	-70.0	2.0	26	34	63	65	40-6"	
118	281	03/07/06	50.1	15	-21.90	-21.90	-72.0	0.0	16	20	23	30	30	
119	236	03/07/06	50.1	15	-21.90	-21.90	-72.0	0.0	23	26	23	30	29	
120	208	03/07/06	50.1	15	-21.90	-21.90	-72.0	0.0	33	27	29	27	14-6"	
121	180	03/07/06	50.1	15	-21.90	-21.90	-72.0	0.0	30	30	25	30	30	
122	154	03/07/06	50.1	15	-21.90	-21.90	-72.0	0.0	25	30	26	37	29	
123	860	03/07/06	61.1	10	-21.90	-21.90	-83.0	0.0	9	10	11	25	34-9"	
124	837	03/07/06	61.1	10	-21.90	-21.90	-83.0	0.0	11	13	11	22	14-4"	
125	838	03/07/06	61.1	10	-21.90	-21.90	-83.0	0.0	6	5	5	31	32-9"	
126	815	03/07/06	61.1	10	-21.90	-21.90	-83.0	0.0	8	10	10	23	26-9"	
127	816	03/07/06	61.1	10	-21.90	-21.90	-83.0	0.0	9	11	14	37	42-9"	
128	927	03/07/06	61.1	10	-21.90	-21.90	-83.0	0.0	7	11	12	14	17-6"	
129	928	03/07/06	61.1	10	-21.90	-21.90	-83.0	0.0	7	8	31	46	67	
130	924	03/07/06	61.1	10	-21.90	-21.90	-83.0	0.0	7	12	27	46	53	
131	930	03/07/06	61.1	10	-21.90	-21.90	-83.0	0.0	6	11	26	37	18-3"	
132	931	03/07/06	61.1	10	-21.90	-21.90	-83.0	0.0	7	13	28	45	19-3"	
133	932	03/07/06	61.1	10	-21.90	-21.90	-83.0	0.0	9	14	20	24	7-2"	
134	933	03/07/06	61.1	10	-21.90	-21.90	-83.0	0.0	4	10	22	27	20-9"	
135	934	03/07/06	61.1	10	-21.90	-21.90	-83.0	0.0	10	15	20	25	9-3"	
136	912	03/07/06	61.1	10	-21.90	-21.90	-83.0	0.0	8	13	22	39	21-6"	
137	911	03/07/06	61.1	10	-21.90	-21.90	-83.0	0.0	6	7	20	42	36-6"	
138	910	03/07/06	61.1	10	-21.90	-21.90	-83.0	0.0	5	8	17	40	53	
139	908	03/07/06	61.1	10	-21.90	-21.90	-83.0	0.0	7	19	26	40	47-10"	
140	907	03/07/06	61.1	10	-21.90	-21.90	-83.0	0.0	7	12	29	58	70-9"	
141	906	03/07/06	61.1	10	-21.90	-21.90	-83.0	0.0	9	14	22	49	42-9"	
142	905	03/07/06	61.1	10	-21.90	-21.90	-83.0	0.0	11	9	12	31	54	
143	282	03/08/06	50.1	15	-21.90	-21.90	-72.0	0.0	16	25	21	24	31	
144	237	03/08/06	50.1	15	-21.90	-21.90	-72.0	0.0	31	32	33	31	34	
145	209	03/08/06	50.1	15	-21.90	-21.90	-72.0	0.0	37	43	42	43	37	
146	181	03/08/06	50.1	15	-21.90	-21.90	-72.0	0.0	38	40	40	41	20-6"	
147	283	03/08/06	50.1	15	-21.90	-21.90	-72.0	0.0	24	24	30	26	32	
148	238	03/08/06	50.1	15	-21.90	-21.90	-72.0	0.0	33	35	38	44	17-6"	
149	210	03/08/06	50.1	15	-21.90	-21.90	-72.0	0.0	40	48	34	42	38	
150	182	03/08/06	50.1	15	-21.90	-21.90	-72.0	0.0	62	57	54	47	25-6"	
151	155	03/08/06	50.1	15	-21.90	-21.90	-72.0	0.0	40	35	38	39	42	



TABLE 1  
Indicator and Production Pile Summary  
301 Mission Street  
San Francisco, California

Treadwell & Rolló Pile No.	Project Pile Number	Date Driven	Furnished Length (feet) <sup>2</sup>	Predrill Depth (feet)	Design Pile-Cutoff Elevation (feet) <sup>3</sup>	Actual Top of Pile Elevation (feet) <sup>3,4</sup>	Approximate Tip Elevation (feet) <sup>3</sup>	Approximate Cut-off Length (feet)	Final Driving (Blows/foot for final 5-feet)					Remarks
152	156	03/08/06	50.1	15	-21.90	-21.90	-72.0	0.0	42	48	40	40	22-6"	
153	111	03/08/06	50.1	15	-21.90	-21.90	-72.0	0.0	39	50	48	54	26-6"	
154	112	03/08/06	50.1	15	-21.90	-21.90	-72.0	0.0	34	34	35	40	35	
155	113	03/08/06	50.1	15	-21.90	-21.90	-72.0	0.0	45	47	38	36	18-6"	
156	89	03/08/06	50.1	15	-21.90	-21.90	-72.0	0.0	32	32	38	32	15-6"	
157	90	03/08/06	50.1	15	-21.90	-21.90	-72.0	0.0	38	40	46	44	21-6"	
158	91	03/08/06	50.1	15	-21.90	-21.90	-72.0	0.0	38	43	55	57	44	
159	23	03/08/06	50.1	15	-21.90	-20.40	-70.5	1.5	12	24	38	44	40-6"	
160	45	03/08/06	50.1	15	-21.90	-21.90	-72.0	0.0	28	42	42	41	22-6"	
161	883	3/7 & 3/8/06	61.1	10	-21.90	-21.90	-83.0	0.0	12	9	15	40	62	
162	884	03/08/06	61.1	10	-21.90	-21.90	-83.0	0.0	9	11	24	45	61	
163	885	03/08/06	61.1	10	-21.90	-21.90	-83.0	0.0	9	17	30	43	36-9"	
164	886	03/08/06	61.1	10	-21.90	-21.90	-83.0	0.0	9	16	38	51	46-6"	
165	887	03/08/06	61.1	10	-21.90	-21.90	-83.0	0.0	9	13	30	52	48-10"	
166	888	03/08/06	61.1	10	-21.90	-21.90	-83.0	0.0	8	14	32	51	23-3"	
167	889	03/08/06	61.1	10	-21.90	-21.90	-83.0	0.0	8	10	29	45	49-9"	
168	890	03/08/06	61.1	10	-21.90	-21.90	-83.0	0.0	7	15	35	51	49-7"	
169	891	03/08/06	61.1	10	-21.90	-21.90	-83.0	0.0	7	8	13	35	53	
170	892	03/08/06	61.1	10	-21.90	-21.90	-83.0	0.0	9	11	33	36	18-5"	
171	913	03/08/06	61.1	10	-21.90	-21.90	-83.0	0.0	6	7	24	50	24-5"	
172	893	03/08/06	61.1	10	-21.90	-21.90	-83.0	0.0	10	9	18	34	22-6"	
173	914	03/08/06	61.1	10	-21.90	-21.90	-83.0	0.0	7	8	16	36	46	
174	935	03/08/06	61.1	10	-21.90	-21.90	-83.0	0.0	6	6	17	42	54	
175	936	03/08/06	61.1	10	-21.90	-21.90	-83.0	0.0	5	14	32	41	6-1"	
176	937	03/08/06	61.1	10	-21.90	-21.90	-83.0	0.0	8	11	28	39	8-2"	
177	938	03/08/06	61.1	10	-21.90	-21.90	-83.0	0.0	11	10	22	35	13-4"	
178	939	03/08/06	61.1	10	-21.90	-21.90	-83.0	0.0	9	12	15	27	30-9"	
179	940	03/08/06	61.1	10	-21.90	-21.90	-83.0	0.0	7	11	11	25	34	
180	941	03/08/06	61.1	10	-21.90	-21.90	-83.0	0.0	9	9	14	26	37	
181	942	03/08/06	61.1	10	-21.90	-21.90	-83.0	0.0	9	12	25	32	11-5"	
182	943	03/08/06	61.1	10	-21.90	-21.90	-83.0	0.0	9	13	25	29	15-6"	
183	944	03/08/06	61.1	10	-21.90	-21.90	-83.0	0.0	10	13	26	33	14-4"	
184	67	03/09/06	50.1	15	-21.90	-21.90	-72.0	0.0	28	35	37	48	38	
185	46	03/09/06	50.1	15	-21.90	-20.40	-70.5	1.5	20	35	54	57	35-6"	
186	68	03/09/06	50.1	15	-21.90	-21.90	-72.0	0.0	30	40	34	48	40	
187	47	03/09/06	50.1	15	-21.90	-20.40	-70.5	1.5	15	25	28	39	36-6"	
188	69	03/09/06	50.1	15	-21.90	-19.90	-70.0	2.0	13	14	39	44	40-6"	
189	945	03/09/06	61.1	10	-21.90	-21.90	-83.0	0.0	8	11	32	46	34-6"	
190	894	03/09/06	61.1	10	-21.90	-21.90	-83.0	0.0	6	10	13	30	39-11"	
191	895	03/09/06	61.1	10	-21.90	-21.90	-83.0	0.0	9	10	22	41	32-6"	
192	896	03/09/06	61.1	10	-21.90	-21.90	-83	0.0	7	10	23	37	31-6"	
193	917	03/09/06	61.1	10	-21.90	-21.90	-83.0	0.0	8	14	25	51	10-2"	
194	897	03/09/06	61.1	10	-21.90	-21.90	-83.0	0.0	8	11	30	45	13-2"	
195	918	03/09/06	61.1	10	-21.90	-21.90	-83.0	0.0	7	9	21	32	36-9"	

TABLE I  
Indicator and Production Pile Summary  
301 Mission Street  
San Francisco, California

Treadwell & Rollo Pile No.	Project Pile Number	Date Driven	Furnished Length (feet) <sup>2</sup>	Predrill Depth (feet)	Design Pile Cutoff Elevation (feet) <sup>3</sup>	Actual Top of Pile Elevation (feet) <sup>3,4</sup>	Approximate Tip Elevation (feet) <sup>3</sup>	Approximate Cut-off Length (feet)	Final Driving (Blows/foot for final 5 feet)					Remarks
									7	8	17	37	45-9"	
196	898	03/09/06	61.1	10	-21.90	-21.90	-83.0	0.0	7	8	17	37	45-9"	
197	919	03/09/06	61.1	10	-21.90	-21.90	-83.0	0.0	6	7	16	26	42	
198	916	03/09/06	61.1	10	-21.90	-21.90	-83.0	0.0	5	8	11	31	47	
199	920	03/09/06	61.1	10	-21.90	-21.90	-83.0	0.0	8	10	26	41	6-1"	
200	899	03/09/06	61.1	10	-21.90	-21.90	-83.0	0.0	7	11	23	42	27-6"	
201	921	03/09/06	61.1	10	-21.90	-21.90	-83.0	0.0	7	11	25	37	47	
202	900	03/09/06	61.1	10	-21.90	-21.90	-83.0	0.0	7	9	23	36	9-2"	
203	923	03/09/06	61.1	10	-21.90	-21.90	-83.0	0.0	9	10	35	55	24-5"	
204	901	03/09/06	61.1	10	-21.90	-21.90	-83.0	0.0	7	7	17	36	48	
205	183	03/10/06	50.1	15	-21.90	-21.90	-72.0	0.0	54	43	50	41	25-6"	
206	157	03/10/06	50.1	15	-21.90	-21.90	-72.0	0.0	34	36	31	44	38	
207	114	03/10/06	50.1	15	-21.90	-21.90	-72.0	0.0	48	42	53	43	18-6"	
208	92	03/10/06	50.1	20	-21.90	-21.90	-72.0	0.0	29	39	37	44	36	
209	70	03/10/06	50.1	20	-21.90	-21.90	-72.0	0.0	30	34	56	48	30-6"	
210	71	03/10/06	50.1	15	-21.90	-20.90	-71.0	1.0	16	24	38	36	63	
211	93	03/10/06	50.1	15	-21.90	-21.90	-72.0	0.0	27	41	53	52	44	
212	115	03/10/06	50.1	15	-21.90	-19.90	-70.0	2.0	21	32	44	57	40-6"	
213	158	03/10/06	50.1	15	-21.90	-21.90	-72.0	0.0	38	51	50	46	27-6"	
214	185	03/10/06	50.1	15	-21.90	-21.90	-72.0	0.0	30	49	31	45	39	
215	72	03/10/06	50.1	15	-21.90	-21.90	-72.0	0.0	12	20	27	53	53	
216	94	03/10/06	50.1	15	-21.90	-20.90	-71.0	1.0	15	23	39	52	36-6"	
217	116	03/10/06	50.1	15	-21.90	-21.90	-72.0	0.0	22	29	56	49	54	
218	137	03/10/06	50.1	15	-21.90	-20.90	-71.0	1.0	28	43	52	53	38-6"	
219	163	03/10/06	50.1	15	-21.90	-19.90	-70.0	2.0	16	40	70	64	33-6"	
220	186	03/10/06	50.1	15	-21.90	-19.90	-70.0	2.0	27	52	70	105	32-3"	
221	73	03/10/06	50.1	15	-21.90	-21.90	-72.0	0.0	23	42	48	42	21-6"	
222	95	03/10/06	50.1	15	-21.90	-21.90	-72.0	0.0	33	52	49	53	54	
223	692	03/10/06	61.1	10	-21.90	-21.90	-83.0	0.0	10	12	27	56	30-6"	
224	720	03/10/06	61.1	10	-21.90	-21.90	-83.0	0.0	9	11	25	52	23-5"	
225	765	03/10/06	61.1	10	-21.90	-21.90	-83.0	0.0	8	8	12	27	45	
226	791	03/10/06	61.1	10	-21.90	-21.90	-83.0	0.0	7	8	12	32	60	
227	817	3/10/2006	61.1	10	-21.90	-21.90	-83.0	0.0	7	12	30	54	17-3"	
228	818	3/10/2006	61.1	10	-21.90	-21.90	-83.0	0.0	7	9	32	52	26-5"	
229	819	3/10/2006	61.1	10	-21.90	-21.90	-83.0	0.0	10	11	22	56	63-11"	
230	820	3/10/2006	61.1	10	-21.90	-21.40	-82.5	0.5	7	9	10	34	62	
231	117	3/13/2006	50.1	15	-21.90	-21.90	-72.0	0.0	41	42	48	46	20-6"	
232	118	3/13/2006	50.1	15	-21.90	-20.90	-71.0	1.0	26	36	48	56	32-6"	
233	284	3/13/2006	50.1	15	-21.90	-21.90	-72.0	0.0	23	21	24	23	15-6"	
234	239	3/13/2006	50.1	15	-21.90	-21.90	-72.0	0.0	29	33	27	36	34	
235	211	3/13/2006	50.1	15	-21.90	-21.90	-72.0	0.0	54	48	38	48	14-3"	
236	212	3/13/2006	50.1	15	-21.90	-21.90	-72.0	0.0	42	43	39	46	48	
237	240	3/13/2006	50.1	15	-21.90	-21.90	-72.0	0.0	42	47	39	36	10-3"	
238	285	3/13/2006	50.1	15	-21.9	-21.9	-72.0	0.0	29	28	37	31	33	
239	241	3/13/2006	50.1	15	-21.9	-21.9	-72.0	0.0	24	42	38	47	53	

TABLE 1  
Indicator and Production Pile Summary  
301 Mission Street  
San Francisco, California

Treadwell & Rollo Pile No.	Project Pile Number	Date Driven	Furnished Length (feet) <sup>2</sup>	Predrill Depth (feet)	Design Pile Cutoff Elevation (feet) <sup>3</sup>	Actual Top of Pile Elevation (feet) <sup>3,4</sup>	Approximate Tip Elevation (feet) <sup>3</sup>	Approximate Cut-off Length (feet)	Final Driving (Blows/foot for final 5 feet)					Remarks
									26	40	54	65	63	
240	213	3/13/2006	50.1	15	-21.9	-19.9	-70.0	2.0	26	40	54	65	63	
241	138	3/13/2006	50.1	15	-21.9	-19.9	-70.0	2.0	19	22	40	59	72	
242	139	3/13/2006	50.1	15	-21.9	-19.9	-70.0	2.0	15	29	45	83	62	
243	164	3/13/2006	50.1	15	-21.9	-19.9	-70.0	2.0	21	28	42	73	65	
244	165	3/13/2006	50.1	15	-21.9	-19.9	-70.0	2.0	20	25	49	88	79	
245	187	3/13/2006	50.1	15	-21.9	-19.9	-70.0	2.0	32	49	74	107	50-6"	
246	188	3/13/2006	50.1	15	-21.9	-19.9	-70.0	2.0	29	68	100	143	82-6"	
247	290	3/13/2006	50.1	15	-21.9	-21.9	-72.0	0.0	33	30	41	37	35	
248	264	3/13/2006	50.1	15	-21.9	-19.9	-70.0	2.0	21	32	45	56	64	
249	861	3/13/2006	61.1	10	-21.9	-21.9	-83.0	0.0	12	12	24	35	50	
250	839	3/13/2006	61.1	10	-21.9	-21.9	-83.0	0.0	8	9	20	45	42-8"	
251	862	3/13/2006	61.1	10	-21.9	-21.9	-83.0	0.0	8	9	14	38	55	
252	840	3/13/2006	61.1	10	-21.9	-21.9	-83.0	0.0	10	10	21	46	75	
253	863	3/13/2006	61.1	10	-21.9	-21.9	-83.0	0.0	9	9	17	51	64	
254	841	3/13/2006	61.1	10	-21.9	-21.15	-82.3	0.8	9	10	11	30	62-9"	
255	864	3/13/2006	61.1	10	-21.9	-21.9	-83.0	0.0	9	9	26	48	45-8"	
256	842	3/13/2006	61.1	10	-21.9	-20.7	-81.8	1.2	14	12	12	20	62	
257	721	3/13/2006	61.1	10	-21.9	-21.9	-83.0	0.0	10	12	24	48	44-8"	
258	792	3/13/2006	61.1	10	-21.9	-21.9	-83.0	0.0	8	12	37	55	8-2"	
259	766	3/13/2006	61.1	10	-21.9	-21.9	-83.0	0.0	9	9	9	41	68	
260	722	3/13/2006	61.1	10	-21.9	-21.9	-83.0	0.0	10	14	34	62	16-3"	
261	694	3/13/2006	61.1	10	-21.9	-21.4	-82.5	0.5	12	10	11	15	62	
262	695	3/13/2006	61.1	10	-21.9	-21.4	-82.5	0.5	10	12	12	34	67	
263	723	3/13/2006	61.1	10	-21.9	-21.4	-82.5	0.5	14	13	16	35	61-7"	
264	745	3/13/2006	61.1	10	-21.9	-21.9	-83.0	0.0	14	16	24	49	50-7"	
265	242	3/14/2006	50.1	15	-21.9	-19.9	-70.0	2.0	23	40	63	73	87	
266	214	3/14/2006	50.1	15	-21.9	-19.9	-70.0	2.0	36	52	60	67	34-6"	
267	215	3/14/2006	50.1	15	-21.9	-19.9	-70.0	2.0	24	32	59	60	33-6"	
268	243	3/14/2006	50.1	15	-21.9	-19.9	-70.0	2.0	24	43	69	78	64	
269	265	3/14/2006	50.1	15	-21.9	-19.9	-70	2	20	30	42	62	61	
270	291	3/14/2006	50.1	15	-21.9	-21.9	-72	0	34	33	47	34	35	
271	216	3/14/2006	50.1	15	-21.9	-19.9	-70	2	30	56	65	71	45-6"	
272	244	3/14/2006	50.1	15	-21.9	-20.9	-71	1	21	48	48	45	67	
273	353	3/14/2006	56.1	15	-21.9	-21.9	-78	0	17	18	16	12	11	Final blowcount < 21 b/ft, capacity is 260 kips - see restrike of pile #393 (3/31/06)
274	310	3/14/2006	56.1	15	-21.9	-21.9	-78	0	21	20	20	14	8-6"	Final blowcount < 21 b/ft, capacity is 260 kips - see restrike of pile #393 (3/31/06)
275	354	3/14/2006	56.1	15	-21.9	-21.9	-78	0	23	19	21	21	12-6"	
276	311	3/14/2006	56.1	15	-21.9	-16.9	-73	5	44	40	45	50	73	
277	359	3/14/2006	56.1	15	-21.9	-21.9	-78	0	30	22	18	20	16	Final blowcount < 21 b/ft, capacity is 260 kips - see restrike of pile #393 (3/31/06)
278	333	3/14/2006	56.1	15	-21.9	-21.9	-78	0	26	28	17	22	15	Final blowcount < 21 b/ft, capacity is 260 kips - see restrike of pile #393 (3/31/06)
279	312	3/14/2006	56.1	15	-21.9	-21.9	-78	0	42	35	28	24	13-6"	
280	360	3/14/2006	56.1	15	-21.9	-21.9	-78	0	24	20	19	15	13	Final blowcount < 21 b/ft, capacity is 260 kips - see restrike of pile #393 (3/31/06)
281	334	3/14/2006	56.1	15	-21.9	-21.9	-78	0	50	38	35	29	25	
282	313	3/14/2006	56.1	15	-21.9	-14.9	-71	7	24	52	65	65	82	
283	266	3/14/2006	56.1	15	-21.9	-13.9	-70	8	16	32	50	109	86	

TABLE 1  
Indicator and Production Pile Summary  
301 Mission Street  
San Francisco, California

Treadwell & Rollo Pile No.	Project/Pile Number <sup>1</sup>	Date Driven	Furnished Length (feet) <sup>2</sup>	Predrill Depth (feet)	Design Pile Cutoff Elevation (feet) <sup>3</sup>	Actual Top of Pile Elevation (feet) <sup>3,4</sup>	Approximate Tip Elevation (feet) <sup>3</sup>	Approximate Cut-off Length (feet)	Final Driving (Blows/foot for final 5 feet)					Remarks
									10	11	13	32	74	
284	771	3/14/2006	61.1	10	-21.9	-21.9	-83	0	10	11	13	32	74	
285	793	3/14/2006	61.1	10	-21.9	-21.65	-82.75	0.25	10	10	12	38	68	
286	664	3/14/2006	61.1	10	-21.9	-21.9	-83	0	10	9	24	43	36-6"	
287	638	3/14/2006	61.1	10	-21.9	-21.9	-83	0	11	10	11	26	27-9"	
288	595	3/14/2006	61.1	10	-21.9	-21.9	-83	0	9	9	14	27	18-6"	
289	569	3/14/2006	61.1	10	-21.9	-21.9	-83	0	8	8	8	13	30	
290	543	3/14/2006	61.1	10	-21.9	-21.9	-83	0	8	10	9	20	29	
291	500	3/14/2006	61.1	10	-21.9	-21.9	-83	0	7	9	12	28	12-3"	
292	665	3/14/2006	61.1	10	-21.9	-21.9	-83	0	7	9	23	51	34-6"	
293	666	3/14/2006	61.1	10	-21.9	-21.9	-83	0	10	11	17	43	64	
294	639	3/14/2006	61.1	10	-21.9	-21.9	-83	0	11	10	15	52	37-5"	
295	596	3/14/2006	61.1	10	-21.9	-21.9	-83	0	9	9	12	26	37	
296	570	3/14/2006	61.1	10	-21.9	-21.9	-83	0	11	10	11	25	24-5"	
297	544	3/14/2006	61.1	10	-21.9	-21.9	-83	0	12	14	20	37	10-3"	
298	501	3/14/2006	61.1	10	-21.9	-21.9	-83	0	8	9	14	17	16-6"	
299	502	3/14/2006	61.1	10	-21.9	-21.9	-83	0	8	8	10	12	21	
300	503	3/14/2006	61.1	10	-21.9	-21.9	-83	0	9	9	9	17	26	
301	524	3/14/2006	61.1	10	-21.9	-21.9	-83	0	11	9	13	31	32-6"	
302	549	3/14/2006	61.1	10	-21.9	-21.9	-83	0	10	12	33	56	12-2"	
303	550	3/14/2006	61.1	10	-21.9	-21.9	-83	0	13	13	15	28	70	
304	292	3/15/2006	56.1	15	-21.9	-13.9	-70	8	22	37	54	67	72	
305	314	3/15/2006	56.1	15	-21.9	-21.9	-78	0	25	24	21	15	9-6"	Final blowcount < 21 b/ft, capacity is 260 kips - see restrike of pile #393 (3/31/06)
306	335	3/15/2006	56.1	15	-21.9	-21.9	-78	0	36	29	26	21	12-6"	
307	361	3/15/2006	56.1	15	-21.9	-21.9	-78	0	26	23	16	18	14	Final blowcount < 21 b/ft, capacity is 260 kips - see restrike of pile #393 (3/31/06)
308	74	3/15/2006	50.1	15	-21.9	-21.9	-72	0	20	30	29	35	36	
309	75	3/15/2006	50.1	15	-21.9	-21.9	-72	0	24	26	30	36	33	
310	76	3/15/2006	50.1	15	-21.9	-21.9	-72	0	16	23	29	30	26	
311	77	3/15/2006	50.1	15	-21.9	-21.9	-72	0	17	29	31	30	15-6"	
312	96	3/15/2006	50.1	20	-21.9	-21.9	-72	0	31	38	41	36	15-6"	
313	97	3/15/2006	50.1	15	-21.9	-21.9	-72	0	28	49	44	49	39	
314	98	3/15/2006	50.1	15	-21.9	-21.9	-72	0	25	44	40	42	28	
315	119	3/15/2006	50.1	15	-21.9	-21.9	-72	0	28	39	44	41	25-9"	
316	140	3/15/2006	50.1	15	-21.9	-21.9	-72	0	58	44	45	36	15-6"	
317	99	3/15/2006	50.1	15	-21.9	-21.9	-72	0	25	28	37	39	17-6"	
318	120	3/15/2006	56.1	15	-21.9	-14.9	-71	7	20	37	39	51	68	
319	575	3/15/2006	61.1	10	-21.9	-21.9	-83	0	11	11	14	27	30-7"	
320	576	3/15/2006	61.1	10	-21.9	-21.9	-83	0	12	11	14	14	5-4"	Final blowcount < 21 b/ft, capacity is 260 kips - see restrike of pile #393 (3/31/06)
321	597	3/15/2006	61.1	10	-21.9	-21.9	-83	0	11	10	10	21	35-10"	
322	598	3/15/2006	61.1	10	-21.9	-21.9	-83	0	11	9	9	15	67	
323	618	3/15/2006	61.1	10	-21.9	-21.9	-83	0	12	13	13	28	38-9"	
324	644	3/15/2006	61.1	10	-21.9	-20.9	-82	1	11	12	14	24	70-9"	
325	667	3/15/2006	61.1	10	-21.9	-21.65	-82.75	0.25	16	16	20	41	61-10"	
326	474	3/15/2006	61.1	10	-21.9	-21.9	-83	0	8	8	10	12	27	
327	448	3/15/2006	61.1	10	-21.9	-21.9	-83	0	10	9	10	11	13-8"	

**TABLE 1**  
**Indicator and Production Pile Summary**  
 301 Mission Street  
 San Francisco, California

Treadwell & Rollo Pile No.	Project Pile Number <sup>1</sup>	Date Driven	Furnished Length (feet) <sup>2</sup>	Predrill Depth (feet)	Design Pile Cutoff Elevation (feet) <sup>3</sup>	Actual Top of Pile Elevation (feet) <sup>3,4</sup>	Approximate Tip Elevation (feet) <sup>3</sup>	Approximate Cut-off Length (feet)	Final Driving (Blows/foot for final 5 feet)					Remarks
									10	10	10	10	10-11"	
328	405	3/15/2006	61.1	10	-21.9	-21.9	-83	0	10	10	10	10	10-11"	Final blowcount < 21 b/f, capacity is 260 kips - see restrike of pile #393 (3/31/06)
329	379	3/15/2006	61.1	10	-21.9	-21.9	-83	0	10	7	10	12	12	Final blowcount < 21 b/f, capacity is 260 kips - see restrike of pile #393 (3/31/06)
330	380	3/15/2006	61.1	10	-21.9	-21.9	-83	0	11	13	9	14	8-6"	Final blowcount < 21 b/f, capacity is 260 kips - see restrike of pile #393 (3/31/06)
331	406	3/15/2006	61.1	10	-21.9	-21.9	-83	0	9	10	9	10	12	Final blowcount < 21 b/f, capacity is 260 kips - see restrike of pile #393 (3/31/06)
332	449	3/15/2006	61.1	10	-21.9	-21.9	-83	0	10	7	10	12	10-6"	Final blowcount < 21 b/f, capacity is 260 kips - see restrike of pile #393 (3/31/06)
333	141	3/16/2006	56.1	15	-21.9	-14.65	-70.75	7.25	22	53	52	57	66	
334	121	3/16/2006	56.1	15	-21.9	-21.9	-78	0	20	26	21	22	21	
335	142	3/16/2006	56.1	15	-21.9	-14.4	-70.5	7.5	20	30	43	45	65	
336	122	3/16/2006	56.1	15	-21.9	-15.15	-71.25	6.75	20	38	40	52	64	
337	143	3/16/2006	56.1	15	-21.9	-21.9	-78	0	25	23	24	23	22	
338	123	3/16/2006	56.1	15	-21.9	-14.9	-71	7	12	22	33	57	72	
339	144	3/16/2006	56.1	15	-21.9	-13.9	-70	8	17	32	56	76	90	
340	475	3/16/2006	61.1	10	-21.9	-21.9	-83	0	13	9	11	16	25-9"	
341	385	3/16/2006	61.1	10	-21.9	-21.9	-83	0	14	13	13	11	11-11"	Final blowcount < 21 b/f, capacity is 260 kips - see restrike of pile #393 (3/31/06)
342	386	3/16/2006	61.1	10	-21.9	-21.9	-83	0	13	16	15	17	15	Final blowcount < 21 b/f, capacity is 260 kips - see restrike of pile #393 (3/31/06)
343	407	3/16/2006	61.1	10	-21.9	-10.33	-71.43	11.57	32	41	50	55	85	
344	408	3/16/2006	61.1	10	-21.9	-10	-71.1	11.9	41	50	67	69	77	
345	428	3/16/2006	61.1	10	-21.9	-10.33	-71.43	11.57	19	34	48	50	64	
346	429	3/16/2006	61.1	10	-21.9	-10	-71.1	11.9	28	34	47	58	68	
347	454	3/16/2006	61.1	10	-21.9	-10.43	-71.53	11.47	25	44	48	60	61	
348	455	3/16/2006	61.1	10	-21.9	-10.33	-71.43	11.57	37	60	95	118	80-10"	
349	480	3/16/2006	61.1	10	-21.9	-10.33	-71.43	11.57	39	58	61	62	81	
350	481	3/16/2006	61.1	10	-21.9	-10	-71.1	11.9	23	35	51	90	110	
351	166	3/17/2006	50.1	15	-21.9	-20.9	-71	1	27	37	62	49	65	
352	189	3/17/2006	50.1	15	-21.9	-20.4	-70.5	1.5	33	35	53	59	62	
353	217	3/17/2006	50.1	15	-21.9	-20.15	-70.25	1.75	21	40	44	60	65	
354	267	3/17/2006	56.1	15	-21.9	-21.9	-78	0	24	22	20	18	17	Final blowcount < 21 b/f, capacity is 260 kips - see restrike of pile #393 (3/31/06)
355	293	3/17/2006	56.1	15	-21.9	-14.9	-71	7	28	46	57	55	98	
356	315	3/17/2006	56.1	15	-21.9	-14.9	-71	7	35	46	59	55	63	
357	336	3/17/2006	56.1	15	-21.9	-14.4	-70.5	7.5	25	46	53	75	88	
358	362	3/17/2006	56.1	15	-21.9	-21.9	-78	0	35	30	26	26	12-6"	
359	363	3/17/2006	56.1	15	-21.9	-14.9	-71	7	40	41	55	56	67	
360	364	3/17/2006	56.1	15	-21.9	-15.9	-72	6	41	39	57	43	65	
361	338	3/17/2006	56.1	15	-21.9	-13.9	-70	8	17	42	70	71	117	
362	316	3/17/2006	56.1	15	-21.9	-14.15	-70.25	7.75	37	60	71	80	46-6"	
363	317	3/17/2006	56.1	15	-21.9	-14.65	-70.75	7.25	39	50	57	66	69	
364	294	3/17/2006	56.1	15	-21.9	-13.9	-70	8	61	60	116	124	100-9"	
365	619	3/17/2006	61.1	10	-21.9	-21.9	-83	0	13	14	16	40	19-4"	
366	645	3/17/2006	61.1	10	-21.9	-21.9	-83	0	15	14	17	34	69-9"	
367	668	3/17/2006	61.1	10	-21.9	-21.4	-82.5	0.5	11	13	15	48	64-9"	
368	696	3/17/2006	61.1	10	-21.9	-21.9	-83	0	12	12	16	49	67-9"	
369	724	3/17/2006	61.1	10	-21.9	-21.9	-83	0	14	11	16	48	84	
370	746	3/17/2006	61.1	10	-21.9	-21.9	-83	0	14	14	14	25	99	
371	772	3/17/2006	61.1	10	-21.9	-20.9	-82	1	14	10	17	25	71-9"	

TABLE 1  
Indicator and Production File Summary  
301 Mission Street  
San Francisco, California

Treadwell & Rollo Pile No.	Project File Number <sup>1</sup>	Date Driven	Furnished Length (feet) <sup>2</sup>	Pycdrill Depth (feet)	Design File Cutoff Elevation (feet) <sup>1</sup>	Actual Top of Pile Elevation (feet) <sup>3,4</sup>	Approximate Tip Elevation (feet)	Approximate Cut-off Length (feet)	Final Driving (Blows/foot for final 5 feet)						Remarks
									11	10	22	58	94		
372	794	3/17/2006	61.1	10	-21.9	-21.9	-83	0	11	10	22	58	94		
373	773	3/17/2006	61.1	10	-21.9	-20.9	-82	1	11	11	14	30	66-9"		
374	747	3/17/2006	61.1	10	-21.9	-21.5	-82.6	0.4	11	11	13	24	64		
375	725	3/17/2006	61.1	10	-21.9	-20.9	-82	1	15	16	20	36	65-9"		
376	697	3/17/2006	61.1	30	-21.9	-21.4	-82.5	0.5	11	12	17	47	62-6"		
377	796	3/17/2006	61.1	30	-21.9	-21.9	-83	0	11	11	13	35	78		
378	245	3/18/2006	50.1	15	-21.9	-19.9	-70	2	21	32	45	69	63		
379	268	3/18/2006	56.1	15	-21.9	-14.4	-70.5	7.5	31	47	61	66	44-6"		
380	246	3/18/2006	56.1	15	-21.9	-13.9	-70	8	32	46	77	103	83		
381	218	3/18/2006	56.1	15	-21.9	-21.9	-78	0	21	10	8	10	12	Pile Broken, no replacement pile needed, see RFI #139	
382	190	3/18/2006	56.1	15	-21.9	-21.9	-78	0	38	9	7	6	7	Pile Broken, no replacement pile needed, see RFI #139	
383	167	3/18/2006	56.1	15	-21.9	-13.9	-70	8	23	29	41	64	72		
384	295	3/18/2006	56.1	15	-21.9	-13.9	-70	8	19	39	65	65	70		
385	269	3/18/2006	56.1	15	-21.9	-13.9	-70	8	19	33	57	66	74		
386	247	3/18/2006	56.1	15	-21.9	-13.9	-70	8	25	42	69	77	76		
387	219	3/18/2006	56.1	15	-21.9	-12.4	-68.5	9.5	69	50	44	66	90		
388	191	3/18/2006	56.1	15	-21.9	-13.9	-70	8	40	65	118	116	45-3"		
389	168	3/18/2006	56.1	15	-21.9	-13.9	-70	8	35	50	84	118	70-6"		
390	169	3/18/2006	56.1	15	-21.9	-13.1	-69.2	8.8	22	42	150	172	35-2"		
391	646	3/18/2006	61.1	10	-21.9	-21.9	-83	0	12	14	29	53	15-2"		
392	669	3/18/2006	61.1	10	-21.9	-21.9	-83	0	15	16	23	57	75-7"		
393	647	3/18/2006	61.1	30	-21.9	-21.9	-83	0	10	9	13	44	9-2"		
394	670	3/18/2006	61.1	30	-21.9	-20.9	-82	1	12	14	16	32	64-8"		
395	698	3/18/2006	61.1	30	-21.9	-19.9	-81	2	29	39	55	54	64-7"		
396	648	3/18/2006	61.1	30	-21.9	-21.9	-83	0	11	9	12	23	99		
397	671	3/18/2006	61.1	30	-21.9	-21.9	-83	0	11	12	13	29	92		
398	699	3/18/2006	61.1	30	-21.9	-21.9	-83	0	12	12	19	37	89		
399	649	3/18/2006	61.1	30	-21.9	-21.9	-83	0	9	10	15	54	32-3"		
400	672	3/18/2006	61.1	35	-21.9	-21.6	-82.7	0.3	10	11	13	21	67		
401	700	3/18/2006	61.1	30	-21.9	-20.9	-82	1	13	15	19	30	68-6"		
402	726	3/18/2006	61.1	30	-21.9	-20.9	-82	1	18	12	13	22	62		
403	748	3/18/2006	61.1	30	-21.9	-20.7	-81.8	1.2	14	16	12	25	65-9"		
404	774	3/18/2006	61.1	30	-21.9	-20.9	-82	1	11	13	14	22	77		
405	504	3/20/2006	51.77	15	-32.9	-32.9	-84.67	0	10	12	15	18	34		
406	505	3/20/2006	51.77	15	-32.9	-32.9	-84.67	0	12	15	22	34	71-6"		
407	506	3/20/2006	55.77	15	-32.9	-32.9	-88.67	0	27	39	57	43	20-6"		
408	507	3/20/2006	55.77	15	-32.9	-32.9	-88.67	0	31	46	51	52	43		
409	525	3/20/2006	51.77	15	-32.9	-32.9	-84.67	0	14	16	32	54	62		
410	526	3/20/2006	51.77	15	-32.9	-31.9	-83.67	1	11	13	23	49	46-6"		
411	879	3/20/2006	61.1	45	-21.9	-21.9	-83	0	8	11	15	30	49		
412	857	3/20/2006	61.1	45	-21.9	-21.9	-83	0	10	10	30	55	23-4"		
413	835	3/20/2006	61.1	45	-21.9	-21.9	-83	0	9	8	16	30	43-9"		
414	813	3/20/2006	61.1	45	-21.9	-21.9	-83	0	9	9	19	45	28-6"		
415	770	3/20/2006	61.1	45	-21.9	-21.9	-83	0	8	7	12	34	24-5"		

TABLE 1  
Indicator and Production Pile Summary  
301 Mission Street  
San Francisco, California

Treadwell & Rollo Pile No.	Project File Number	Date Driven	Furnished Length (feet) <sup>2</sup>	Predrill Depth (feet)	Design Pile Cutoff Elevation (feet) <sup>1</sup>	Actual Top of Pile Elevation (feet) <sup>3,4</sup>	Approximate Tip Elevation (feet) <sup>3</sup>	Approximate Cut-off Length (feet)	Final Driving (Blows/foot for final 5 feet)					Remarks
									11	11	15	42	64-9"	
416	749	3/20/2006	61.1	35	-21.9	-21.6	-82.7	0.3	11	11	15	42	64-9"	
417	775	3/20/2006	61.1	35	-21.9	-21.9	-83	0	13	12	16	50	67	
418	797	3/20/2006	61.1	35	-21.9	-21.9	-83	0	9	9	12	34	35-6"	
419	822	3/20/2006	61.1	0	-21.9	-21.9	-83	0	8	10	13	28	39-9"	
420	844	3/20/2006	61.1	35	-21.9	-21.9	-83	0	7	8	14	50	50	
421	866	3/20/2006	61.1	35	-21.9	-21.9	-83	0	7	10	22	35	58	
422	821	3/20/2006	61.1	35	-21.9	-21.9	-83	0	9	8	14	38	89	
423	387	3/21/2006	56.1	15	-21.9	-21.9	-78	0	20	19	15	18	15	Final blowcount < 21 b/f, capacity is 260 kips - see restrike of pile #393 (3/31/06)
424	388	3/21/2006	56.1	15	-21.9	-21.9	-78	0	22	20	13	15	12	Final blowcount < 21 b/f, capacity is 260 kips - see restrike of pile #393 (3/31/06)
425	389	3/21/2006	56.1	15	-21.9	-21.9	-78	0	47	39	41	31	14-6"	
426	390	3/21/2006	56.1	15	-21.9	-21.9	-78	0	28	28	18	20	15	Final blowcount < 21 b/f, capacity is 260 kips - see restrike of pile #393 (3/31/06)
427	88	3/21/2006	50.1	45	-21.9	-19.9	-70	2	33	36	60	81	112	
428	110	3/21/2006	50.1	45	-21.9	-19.9	-70	2	22	24	35	59	63	
429	136	3/21/2006	56.1	45	-21.9	-14.65	-70.75	7.25	36	52	66	79	50-6"	
430	162	3/21/2006	56.1	45	-21.9	-13.9	-70	8	28	32	47	73	75	
431	207	3/21/2006	56.1	45	-21.9	-21.9	-78	0	50	46	26	29	36	
432	235	3/21/2006	56.1	45	-21.9	-21.9	-78	0	32	36	28	29	35	
433	263	3/21/2006	56.1	45	-21.9	-14.9	-71	7	13	13	37	65	71	
434	843	3/21/2006	61.1	30	-21.9	-21.9	-83	0	10	12	13	29	70	
435	865	3/21/2006	61.1	35	-21.9	-21.9	-83	0	10	15	30	52	34-6"	
436	823	3/21/2006	61.1	35	-21.9	-21.9	-83	0	10	9	17	35	31-6"	
437	845	3/21/2006	61.1	35	-21.9	-21.9	-83	0	10	11	16	42	51	
438	867	3/21/2006	61.1	35	-21.9	-21.9	-83	0	11	16	42	54	25-3"	
439	744	3/21/2006	61.1	45	-21.9	-21.9	-83	0	7	8	10	25	38-9"	
440	688	3/21/2006	61.1	45	-21.9	-21.9	-83	0	14	12	19	39	30-5"	
441	643	3/21/2006	61.1	45	-21.9	-21.9	-83	0	17	12	14	15	11-6"	
442	617	3/21/2006	61.1	45	-21.9	-21.9	-83	0	18	11	11	11	4-3"	Final blowcount < 21 b/f, capacity is 260 kips - see restrike of pile #393 (3/31/06)
443	574	3/21/2006	61.1	45	-21.9	-21.9	-83	0	18	12	10	10	9-9"	Final blowcount < 21 b/f, capacity is 260 kips - see restrike of pile #393 (3/31/06)
444	551	3/21/2006	51.77	10	-32.9	-32.9	-84.67	0	14	13	25	63	92	
445	289	3/22/2006	56.1	45	-21.9	-14.9	-71	7	16	32	42	44	67	
446	332	3/22/2006	56.1	45	-21.9	-15.9	-72	6	32	44	51	58	62	
447	358	3/22/2006	56.1	45	-21.9	-21.9	-78	0	25	27	32	27	26	
448	384	3/22/2006	56.1	45	-21.9	-21.9	-78	0	21	19	22	22	17-9"	
449	427	3/22/2006	56.1	45	-21.9	-21.9	-78	0	31	28	30	26	23	
450	87	3/22/2006	50.1	45	-21.9	-20.4	-70.5	1.5	25	26	48	55	73	
451	109	3/22/2006	50.1	45	-21.9	-19.9	-70	2	23	45	55	87	30-3"	
452	135	3/22/2006	56.1	45	-21.9	-19.9	-76	2	6	6	4	2	2	Pile Broken, replacement pile (#135-R) driven on 4/17/06 see RF1 #163
453	161	3/22/2006	56.1	45	-21.9	-13.9	-70	8	22	33	46	48	35-6"	
454	206	3/22/2006	56.1	45	-21.9	-14.9	-71	7	18	35	43	47	67	
455	205	3/22/2006	56.1	45	-21.9	-13.9	-70	8	21	24	30	54	70	
456	160	3/22/2006	56.1	45	-21.9	-9.4	-65.5	12.5	34	62	77	76	45-6"	
457	134	3/22/2006	56.1	40	-21.9	-11.4	-67.5	10.5	71	58	42	44	17-2"	
458	577	3/22/2006	51.77	10	-32.9	-32.9	-84.67	0	12	21	38	47	72	
459	599	3/22/2006	51.77	10	-32.9	-32.9	-84.67	0	14	18	30	52	90	

**TABLE I**  
**Indicator and Production Pile Summary**  
**301 Mission Street**  
**San Francisco, California**

Treadwell & Rollo Pile No.	Project Pile Number <sup>1</sup>	Date Driven	Furnished Length (feet) <sup>2</sup>	Predrill Depth (feet)	Design Pile Cutoff Elevation (feet) <sup>3</sup>	Actual Top of Pile Elevation (feet) <sup>3,4</sup>	Approximate Tip Elevation (feet) <sup>3</sup>	Approximate Cut-off Length (feet)	Final Driving (Blows/foot for final 5 feet)					Remarks
									14	15	20	56	79	
460	620	3/22/2006	51.77	10	-32.9	-31.9	-83.67	1	14	15	20	56	79	
461	409	3/22/2006	46.77	10	-32.9	-32.9	-79.67	0	20	18	16	14	13	Final blowcount < 21 b/ft, capacity is 260 kips - see restrike of pile #393 (3/31/06)
462	410	3/22/2006	46.77	10	-32.9	-32.9	-79.67	0	22	21	20	19	17	Final blowcount < 21 b/ft, capacity is 260 kips - see restrike of pile #393 (3/31/06)
463	411	3/22/2006	46.77	10	-32.9	-32.9	-79.67	0	65	65	45	35	30	
464	412	3/22/2006	46.77	10	-32.9	-32.9	-79.67	0	34	30	27	23	32	
465	432	3/22/2006	55.77	10	-32.9	-32.9	-88.67	0	21	29	81	73	50-6"	
466	458	3/22/2006	55.77	10	-32.9	-31.9	-87.67	1	22	25	31	57	67-9"	
467	484	3/22/2006	55.77	10	-32.9	-30.4	-86.17	2.5	16	20	21	43	64	
468	527	3/22/2006	55.77	10	-32.9	-29.4	-85.17	3.5	13	22	54	57	79	
469	108	3/23/2006	50.1	45	-21.9	-10	-60.1	11.9	14	23	36	65	75-6"	
470	86	3/23/2006	50.1	45	-21.9	-18.9	-69	3	34	35	41	62	92	
471	234	3/23/2006	56.1	45	-21.9	-14.4	-70.5	7.5	18	15	22	52	62	
472	262	3/23/2006	56.1	45	-21.9	-14.1	-70.2	7.8	19	17	37	54	68	
473	288	3/23/2006	56.1	45	-21.9	-15.7	-71.8	6.2	29	50	49	53	62	
474	331	3/23/2006	56.1	45	-21.9	-21.9	-78	0	43	35	33	34	16-6"	
475	357	3/23/2006	56.1	45	-21.9	-21.9	-78	0	42	47	38	35	31	
476	383	3/23/2006	56.1	45	-21.9	-21.9	-78	0	43	43	37	31	28	
477	426	3/23/2006	56.1	45	-21.9	-21.9	-78	0	29	24	23	23	22	
478	233	3/23/2006	56.1	45	-21.9	-13.9	-70	8	20	23	34	82	40-6"	
479	261	3/23/2006	56.1	45	-21.9	-13.9	-70	8	21	22	27	74	77	
480	287	3/23/2006	56.1	45	-21.9	-14.9	-71	7	21	26	45	59	65	
481	330	3/23/2006	56.1	45	-21.9	-13.9	-70	8	19	28	36	50	93	
482	356	3/23/2006	56.1	45	-21.9	-21.9	-78	0	28	27	27	24	24	
483	453	3/23/2006	64.1	45	-21.9	-21.9	-86	0	8	9	7	8	9-6"	Final blowcount < 21 b/ft, capacity is 260 kips - see restrike of pile #393 (3/31/06)
484	479	3/23/2006	65.1	45	-21.9	-21.9	-87	0	10	17	20	48	61	
485	522	3/23/2006	65.1	45	-21.9	-21.9	-87	0	14	13	21	29	70	
486	548	3/23/2006	65.1	45	-21.9	-19.9	-85	2	21	21	26	71	65	
487	431	3/23/2006	51.77	10	-32.9	-32.9	-84.67	0	18	19	24	29	13-4"	
488	430	3/23/2006	51.77	10	-32.9	-32.9	-84.67	0	26	33	34	47	10-3"	
489	457	3/23/2006	51.77	10	-32.9	-22.4	-74.17	10.5	98	101	98	54	45	
490	456	3/23/2006	51.77	10	-32.9	-17.9	-69.67	15	43	71	96	97	20-3"	
491	482	3/23/2006	51.77	35	-32.9	-32.9	-84.67	0	18	24	29	56	82	
492	452	3/24/2006	65.1	45	-21.9	-21.9	-87	0	14	17	34	54	75	
493	478	3/24/2006	65.1	45	-21.9	-21.9	-87	0	19	16	28	55	78	
494	521	3/24/2006	65.1	45	-21.9	-21.9	-87	0	48	30	58	81	45-6"	
495	547	3/24/2006	65.1	45	-21.9	-21.9	-87	0	20	33	54	85	46-6"	
496	520	3/24/2006	65.1	45	-21.9	-21.9	-87	0	12	19	34	75	88	
497	451	3/24/2006	65.1	45	-21.9	-9.9	-75	12	52	66	57	60	107	
498	425	3/24/2006	56.1	45	-21.9	-21.9	-78	0	27	23	25	21	22	
499	573	3/24/2006	61.1	45	-21.9	-21.9	-83	0	28	18	17	16	8-6"	Final blowcount < 21 b/ft, capacity is 260 kips - see restrike of pile #393 (3/31/06)
500	616	3/24/2006	61.1	45	-21.9	-21.9	-83	0	21	18	12	13	12	Final blowcount < 21 b/ft, capacity is 260 kips - see restrike of pile #393 (3/31/06)
501	483	3/24/2006	51.77	35	-32.9	-19.9	-71.67	13	68	80	110	95	85	
502	552	3/24/2006	51.77	15	-32.9	-30.9	-82.67	2	14	15	20	44	72-10"	
503	578	3/24/2006	51.77	35	-32.9	-31.9	-83.67	1	12	14	23	58	79-10"	



TABLE 1  
Indicator and Production Pile Summary  
301 Mission Street  
San Francisco, California

Treadwell & Rollo Pile No.	Project File Number <sup>1</sup>	Date Driven	Furnished Length (feet) <sup>2</sup>	Pre-drill Depth (feet)	Design Pile Cutoff Elevation (feet) <sup>3</sup>	Actual Top of Pile Elevation (feet) <sup>3,4</sup>	Approximate Tip Elevation (feet) <sup>3</sup>	Approximate Cutoff Length (feet)	Final Driving (Blows/foot for final 5 feet)					Remarks
504	600	3/24/2006	51.77	35	-32.9	-31.9	-83.67	1	14	16	20	57	73-9"	
505	621	3/24/2006	51.77	35	-32.9	-30.9	-82.67	2	20	25	25	65	32-3"	
506	553	3/24/2006	55.77	35	-32.9	-19.9	-75.67	13	110	75	61	60	104	
507	579	3/24/2006	51.77	35	-32.9	-31.9	-83.67	1	19	14	17	28	98	
508	601	3/24/2006	51.77	35	-32.9	-20.9	-72.67	12	40	67	108	116	97	
509	622	3/24/2006	51.77	35	-32.9	-31.4	-83.17	1.5	20	18	20	39	40-4"	
510	78	3/27/2006	50.1	15	-21.9	-21.9	-72	0	20	25	31	30	24	
511	79	3/27/2006	50.1	15	-21.9	-21.9	-72	0	19	22	29	27	27	
512	80	3/27/2006	50.1	15	-21.9	-21.9	-72	0	22	24	33	28	33	
513	81	3/27/2006	50.1	15	-21.9	-21.9	-72	0	22	24	36	28	33	
514	82	3/27/2006	50.1	15	-21.9	-21.9	-72	0	34	33	45	38	32-9"	
515	83	3/27/2006	50.1	15	-21.9	-20.15	-70.25	1.75	28	36	52	49	65	
516	100	3/27/2006	50.1	15	-21.9	-21.9	-72	0	17	26	30	32	27	
517		3/27/2006	50.1	15	-21.9	-21.9	-72	0	29	31	35	38	17-6"	
518	102	3/27/2006	50.1	15	-21.9	-21.9	-72	0	30	32	40	32	15-6"	
519	103	3/27/2006	50.1	15	-21.9	-21.9	-72	0	33	35	43	37	20-9"	
520	104	3/27/2006	50.1	15	-21.9	-21.9	-72	0	30	40	38	58	48	
521	105	3/27/2006	50.1	15	-21.9	-19.9	-70	2	31	33	46	50	70	
522	124	3/27/2006	56.1	15	-21.9	-21.9	-78	0	26	27	26	23	11-6"	
523	125	3/27/2006	56.1	15	-21.9	-21.9	-78	0	24	30	24	24	11-6"	
524	126	3/27/2006	56.1	15	-21.9	-21.9	-78	0	26	31	26	24	22	
525	743	3/27/2006	61.1	45	-21.9	-21.9	-83	0	9	12	17	58	35-6"	
526	715	3/27/2006	61.1	45	-21.9	-21.9	-83	0	16	10	32	80	18-2"	
527	687	3/27/2006	61.1	45	-21.9	-21.9	-83	0	17	14	19	53	26-4"	
528	642	3/27/2006	61.1	45	-21.9	-21.9	-83	0	15	17	18	22	51	
529	572	3/27/2006	61.1	45	-21.9	-22.9	-84	-1	12	10	9	11	15	Final blowcount < 21 b/f, capacity is 260 kips - see restrick of pile #393 (3/31/06)
530	615	3/27/2006	61.1	45	-21.9	-21.9	-83	0	18	20	17	16	14-7"	
531	641	3/27/2006	61.1	45	-21.9	-21.9	-83	0	20	20	19	25	69	
532	686	3/27/2006	61.1	45	-21.9	-21.9	-83	0	21	18	18	45	118	
533	714	3/27/2006	61.1	45	-21.9	-21.9	-83	0	17	16	19	52	116-9"	
534	742	3/27/2006	61.1	45	-21.9	-21.9	-83	0	10	10	18	61	49-6"	
535	769	3/27/2006	61.1	45	-21.9	-21.9	-83	0	9	8	12	33	72	
536	812	3/27/2006	61.1	45	-21.9	-21.9	-83	0	8	11	12	35	56	
537	834	3/27/2006	61.1	45	-21.9	-21.9	-83	0	10	11	37	70	22-3"	
538	485	3/28/2006	55.77	15	-32.9	-32.9	-88.67	0	30	36	37	64	30-6"	
539	459	3/28/2006	55.77	15	-32.9	-32.9	-88.67	0	21	27	40	47	74	
540	433	3/28/2006	55.77	15	-32.9	-32.9	-88.67	0	23	31	46	57	78	
541	127	3/28/2006	56.1	15	-21.9	-14.4	-70.5	7.5	19	29	60	72	112	
542	128	3/28/2006	56.1	15	-21.9	-21.9	-78	0	31	33	29	27	24	
543	129	3/28/2006	56.1	15	-21.9	-13.9	-70	8	55	32	66	62	82	
544	130	3/28/2006	56.1	15	-21.9	-8.4	-64.5	13.5	23	39	85	103	101	
545	84	3/28/2006	50.1	15	-21.9	-19.9	-70	2	49	53	50	57	70	
546	85	3/28/2006	50.1	15	-21.9	-17.4	-67.5	4.5	115	73	51	71	33-3"	
547	106	3/28/2006	50.1	45	-21.9	-18.4	-68.5	3.5	110	70	55	54	81	

TABLE 1  
Indicator and Production File Summary  
301 Mission Street  
San Francisco, California

Treadwell & Rollo Pile No.	Project File Number	Date Driven	Furnished Length (feet) <sup>2</sup>	Predrill Depth (feet)	Design Pile Cutoff Elevation (feet) <sup>3</sup>	Actual Top of Pile Elevation (feet) <sup>3,4</sup>	Approximate Tip Elevation (feet) <sup>3</sup>	Approximate Cut-off Length (feet)	Final Driving (Blows/foot for final 5 feet)					Remarks
548	107	3/28/2006	50.1	15	-21.9	-16.9	-67	5	95	52	44	63	88	
549	131	3/28/2006	56.1	15	-21.9	-7.4	-63.5	14.5	17	35	67	123	85-6"	
550	623	3/28/2006	51.77	35	-32.9	-32.9	-84.67	0	18	22	58	113	29-2"	
551	856	3/28/2006	61.1	45	-21.9	-21.9	-83	0	9	12	30	44	28-5"	
552	878	3/28/2006	61.1	45	-21.9	-21.9	-83	0	8	10	22	44	31-6"	
553	811	3/28/2006	61.1	45	-21.9	-21.9	-83	0	11	11	33	50	13-2"	
554	768	3/28/2006	61.1	45	-21.9	-21.9	-83	0	8	10	12	34	46-11"	
555	833	3/28/2006	61.1	45	-21.9	-21.9	-83	0	10	12	36	62	34-5"	
556	855	3/28/2006	61.1	45	-21.9	-21.9	-83	0	9	9	16	32	13-3"	
557	877	3/28/2006	61.1	45	-21.9	-21.9	-83	0	12	15	38	63	9-7"	Pile Broken, replacement pile (#877-R) driven on 4/20/06 see RFI #163
558	832	3/28/2006	61.1	10	-21.9	-21.9	-83	0	10	12	30	57	31-4"	
559	854	3/28/2006	61.1	10	-21.9	-21.9	-83	0	10	17	38	68	29-4"	
560	876	3/28/2006	61.1	10	-21.9	-21.9	-83	0	11	15	39	74	36-5"	
561	528	3/28/2006	55.77	35	-32.9	-27.9	-83.67	5	12	13	32	65	73	
562	554	3/28/2006	55.77	35	-32.9	-27.1	-82.87	5.8	14	15	18	73	64-6"	
563	413	3/29/2006	46.77	15	-32.9	-32.9	-79.67	0	35	24	19	13	12	Final blowcount < 21 b/ft, capacity is 260 kips - see restrike of pile #393 (3/31/06)
564	391	3/29/2006	56.1	15	-21.9	-20.9	-77	1	35	35	25	22	21	
565	365	3/29/2006	56.1	15	-21.9	-21.9	-78	0	29	24	21	17	8-6"	Final blowcount < 21 b/ft, capacity is 260 kips - see restrike of pile #393 (3/31/06)
566	339	3/29/2006	56.1	15	-21.9	-21.9	-78	0	26	30	21	21	17	Final blowcount < 21 b/ft, capacity is 260 kips - see restrike of pile #393 (3/31/06)
567	318	3/29/2006	56.1	15	-21.9	-21.9	-78	0	26	26	23	19	16	Final blowcount < 21 b/ft, capacity is 260 kips - see restrike of pile #393 (3/31/06)
568	296	3/29/2006	56.1	15	-21.9	-21.9	-78	0	28	27	20	20	17	Final blowcount < 21 b/ft, capacity is 260 kips - see restrike of pile #393 (3/31/06)
569	270	3/29/2006	56.1	15	-21.9	-21.9	-78	0	22	23	26	20	15	Final blowcount < 21 b/ft, capacity is 260 kips - see restrike of pile #393 (3/31/06)
570	248	3/29/2006	56.1	15	-21.9	-21.9	-78	0	22	27	22	21	21	
571	220	3/29/2006	56.1	15	-21.9	-13.9	-70	8	23	36	66	81	90	
572	192	3/29/2006	56.1	15	-21.9	-11.9	-68	10	87	73	49	48	102	
573	170	3/29/2006	56.1	15	-21.9	-21.9	-78	0	29	29	26	24	12-6"	
574	580	3/29/2006	51.77	35	-32.9	-30.9	-82.67	2	16	17	18	17	73	
575	602	3/29/2006	51.77	35	-32.9	-31.9	-83.67	1	13	16	22	46	62-6"	
576	868	3/29/2006	61.1	10	-21.9	-21.9	-83	0	9	15	35	47	14-3"	
577	846	3/29/2006	61.1	35	-21.9	-21.9	-83	0	9	12	30	46	38-6"	
578	824	3/29/2006	61.1	20	-21.9	-21.9	-83	0	8	12	21	30	21-4"	
579	869	3/29/2006	61.1	35	-21.9	-21.9	-83	0	8	8	19	30	65	
580	847	3/29/2006	61.1	35	-21.9	-21.9	-83	0	8	10	16	35	49	
581	825	3/29/2006	61.1	10	-21.9	-21.9	-83	0	8	9	11	23	58	
582	848	3/29/2006	61.1	35	-21.9	-21.9	-83	0	7	9	11	29	56	
583	870	3/29/2006	61.1	35	-21.9	-21.9	-83	0	8	10	34	72	37-4"	
584	826	3/29/2006	61.1	10	-21.9	-21.9	-83	0	10	10	15	34	53	
585	871	3/29/2006	61.1	10	-21.9	-21.9	-83	0	9	10	36	50	22-3"	
586	849	3/29/2006	61.1	10	-21.9	-21.9	-83	0	9	9	12	21	39	
587	827	3/29/2006	61.1	10	-21.9	-21.9	-83	0	11	14	30	57	21-4"	
588	872	3/29/2006	61.1	10	-21.9	-21.9	-83	0	10	17	42	53	15-3"	
589	193	3/30/2006	56.1	15	-21.9	-11.9	-68	10	44	33	37	77	30-3"	
590	221	3/30/2006	56.1	15	-21.9	-21.9	-78	0	25	47	36	28	13-6"	
591	249	3/30/2006	56.1	15	-21.9	-21.9	-78	0	34	37	38	33	31	

TABLE 1  
Indicator and Production Pile Summary  
301 Mission Street  
San Francisco, California

Treadwell & Rollo Pile No.	Project Pile Number <sup>1</sup>	Date Driven	Furnished Length (feet) <sup>2</sup>	Predrill Depth (feet)	Design Pile Cutoff Elevation (feet) <sup>3</sup>	Actual Top of Pile Elevation (feet) <sup>3,4</sup>	Approximate Tip Elevation (feet)	Approximate Cut-off Length (feet)	Final Driving (Blows/foot for final 5 feet)					Remarks
									16	35	55	78	86	
592	271	3/30/2006	56.1	15	-21.9	-13.9	-70	8	16	35	55	78	86	
593	297	3/30/2006	56.1	15	-21.9	-16.9	-73	5	74	63	69	58	65	
594	319	3/30/2006	56.1	15	-21.9	-21.9	-78	0	41	36	27	23	11-6"	
595	340	3/30/2006	56.1	15	-21.9	-13.9	-70	8	19	38	49	69	84	
596	366	3/30/2006	56.1	15	-21.9	-21.9	-78	0	38	35	25	22	21	
597	392	3/30/2006	56.1	15	-21.9	-21.9	-78	0	33	25	24	17	16	Final blowcount < 21 b/ft, capacity is 260 kips - see restrike of pile #393 (3/31/06)
598	145	3/30/2006	56.1	15	-21.9	-21.9	-78	0	29	27	34	29	23	
599	171	3/30/2006	56.1	15	-21.9	-13.9	-70	8	32	30	48	61	80	
600	146	3/30/2006	56.1	15	-21.9	-21.9	-78	0	44	34	41	33	27	
601	850	3/30/2006	61.1	10	-21.9	-21.9	-83	0	10	13	34	68	18-3"	
602	873	3/30/2006	61.1	10	-21.9	-21.9	-83	0	10	16	34	59	15-3"	
603	851	3/30/2006	61.1	10	-21.9	-21.9	-83	0	8	11	19	60	79	
604	874	3/30/2006	61.1	35	-21.9	-21.9	-83	0	9	11	30	52	48-9"	
605	852	3/30/2006	61.1	35	-21.9	-21.9	-83	0	10	10	15	50	80	
606	853	3/30/2006	61.1	35	-21.9	-21.9	-83	0	11	12	16	38	82	
607	875	3/30/2006	61.1	35	-21.9	-21.9	-83	0	10	17	35	58	51-9"	
608	831	3/30/2006	61.1	10	-21.9	-21.9	-83	0	10	11	18	50	35-7"	
609	728	3/30/2006	61.1	10	-21.9	-21.9	-83	0	32	33	34	55	76	
610	750	3/30/2006	61.1	35	-21.9	-21.9	-83	0	15	18	23	65	63-9"	
611	776	3/30/2006	61.1	35	-21.9	-21.9	-83	0	10	20	26	84	80-6"	
612	798	3/30/2006	61.1	35	-21.9	-21.9	-83	0	12	13	19	35	63	
613	172	3/31/2006	56.1	15	-21.9	-13.9	-70	8	21	33	52	71	84	
614	195	3/31/2006	56.1	15	-21.9	-13.9	-70	8	26	36	60	94	105	
615	222	3/31/2006	56.1	15	-21.9	-13.9	-70	8	21	36	57	60	80	
616	250	3/31/2006	56.1	15	-21.9	-13.9	-70	8	21	30	56	64	72	
617	272	3/31/2006	56.1	15	-21.9	-13.9	-70	8	26	42	56	66	85	
618	298	3/31/2006	56.1	15	-21.9	-13.9	-70	8	44	52	78	93	45-6"	
619	320	3/31/2006	56.1	15	-21.9	-13.9	-70	8	39	53	76	75	43-6"	
620	341	3/31/2006	56.1	15	-21.9	-13.9	-70	8	22	36	64	103	46-6"	
621	367	3/31/2006	56.1	15	-21.9	-13.9	-70	8	23	43	59	72	42-6"	
622	223	3/31/2006	56.1	15	-21.9	-13.9	-70	8	21	36	55	75	82	
623	251	3/31/2006	56.1	15	-21.9	-21.9	-78	0	40	33	28	30	13-6"	
624	273	3/31/2006	56.1	15	-21.9	-21.9	-78	0	36	29	27	25	23	
625	393	3/31/2006	56.1	15	-21.9	-21.65	-77.75	0.25	34	28	22	17	19-3"	Restrike performed on final 3-inches of driving on 4/1/06
626	729	3/31/2006	61.1	35	-21.9	-21.9	-83	0	11	13	14	31	82	
627	701	3/31/2006	61.1	35	-21.9	-21.9	-83	0	10	12	20	59	29-5"	
628	673	3/31/2006	61.1	35	-21.9	-21.9	-83	0	10	14	22	60	44-6"	
629	650	3/31/2006	61.1	35	-21.9	-21.9	-83	0	10	11	14	39	49-9"	
630	730	3/31/2006	61.1	35	-21.9	-21.9	-83	0	9	9	11	16	60	
631	702	3/31/2006	61.1	35	-21.9	-21.9	-83	0	10	9	13	43	62-7"	
632	674	3/31/2006	61.1	35	-21.9	-21.9	-83	0	10	10	11	46	40-6"	
633	651	3/31/2006	61.1	35	-21.9	-21.9	-83	0	9	12	13	40	69-9"	
634	731	3/31/2006	61.1	35	-21.9	-21.9	-83	0	10	12	14	46	52-6"	
635	703	3/31/2006	61.1	35	-21.9	-21.9	-83	0	11	10	12	32	71-9"	

**TABLE 1**  
**Indicator and Production Pile Summary**  
 301 Mission Street  
 San Francisco, California

Treadwell & Rollo Pile No.	Project Pile Number	Date Driven	Furnished Length (feet) <sup>2</sup>	Predrill Depth (feet)	Design Pile Cutoff Elevation (feet) <sup>3</sup>	Actual Top of Pile Elevation (feet) <sup>4</sup>	Approximate Tip Elevation (feet) <sup>3</sup>	Approximate Cut-off Length (feet)	Final Driving (Blows/foot for final 5 feet)					Remarks
									11	12	24	72	29-3"	
636	675	3/31/2006	61.1	35	-21.9	-21.9	-83	0	11	12	24	72	29-3"	
637	652	3/31/2006	61.1	35	-21.9	-21.9	-83	0	11	12	27	70	51-6"	
638	732	3/31/2006	61.1	35	-21.9	-21.9	-83	0	10	10	13	56	50-6"	
639	704	3/31/2006	61.1	35	-21.9	-21.9	-83	0	10	10	13	47	80	
640	299	4/1/2006	56.1	15	-21.9	-13.9	-70	8	27	33	48	72	46-6"	
641	321	4/1/2006	56.1	15	-21.9	-13.9	-70	8	34	38	60	79	82	
642	342	4/1/2006	56.1	15	-21.9	-21.9	-78	0	41	39	30	26	24	
643	368	4/1/2006	56.1	15	-21.9	-21.9	-78	0	31	31	24	22	19	Final blowcount < 21 b/ft, capacity is 260 kips - see restrike of pile #393 (3/31/06)
644	394	4/1/2006	56.1	15	-21.9	-21.9	-78	0	34	28	26	27	23	
645	434	4/1/2006	55.77	15	-32.9	-32.9	-88.67	0	23	51	61	58	32-9"	
646	414	4/1/2006	46.77	15	-32.9	-32.9	-79.67	0	25	20	18	23	17	Final blowcount < 21 b/ft, capacity is 260 kips - see restrike of pile #393 (3/31/06)
647	415	4/1/2006	46.77	15	-32.9	-22.9	-69.67	10	32	45	68	88	105	
648	416	4/1/2006	46.77	15	-32.9	-32.9	-79.67	0	35	31	30	24	12-6"	
649	460	4/1/2006	55.77	15	-32.9	-32.9	-88.67	0	32	68	73	54	22-6"	
650	676	4/1/2006	61.1	35	-21.9	-21.9	-83	0	15	15	22	66	25-3"	
651	627	4/1/2006	51.77	35	-32.9	-32.9	-84.67	0	13	24	57	79	30-4"	
652	606	4/1/2006	51.77	35	-32.9	-31.9	-83.67	1	9	12	28	56	60-4"	
653	584	4/1/2006	51.77	35	-32.9	-32.9	-84.67	0	13	33	54	55	13-3"	
654	624	4/1/2006	51.77	35	-32.9	-32.9	-84.67	0	13	14	16	38	79	
655	603	4/1/2006	51.77	35	-32.9	-32.9	-84.67	0	13	14	15	19	56	
656	581	4/1/2006	51.77	35	-32.9	-31.9	-83.67	1	12	14	16	55	79-9"	
657	625	4/1/2006	51.77	35	-32.9	-31.9	-83.67	1	13	13	13	20	63	
658	604	4/1/2006	51.77	35	-32.9	-31.9	-83.67	1	16	16	15	30	97	
659	582	4/1/2006	51.77	35	-32.9	-31.9	-83.67	1	13	13	16	54	70-9"	
660	626	4/1/2006	51.77	35	-32.9	-30.9	-82.67	2	15	16	19	20	69	
661	605	4/1/2006	51.77	35	-32.9	-31.9	-83.67	1	18	17	18	30	90	
662	583	4/1/2006	51.77	35	-32.9	-30.9	-82.67	2	18	17	15	19	73	
663	147	4/3/2006	56.1	15	-21.9	-14.9	-71	7	26	30	58	81	78	
664	173	4/3/2006	56.1	15	-21.9	-13.9	-70	8	16	27	53	87	48-6"	
665	148	4/3/2006	56.1	15	-21.9	-21.9	-78	0	38	38	28	28	11-6"	
666	196	4/3/2006	56.1	15	-21.9	-13.4	-69.5	8.5	24	28	48	86	60-6"	
667	174	4/3/2006	56.1	15	-21.9	-13.4	-69.5	8.5	32	22	25	61	110	
668	149	4/3/2006	56.1	15	-21.9	-14.9	-71	7	20	42	66	73	75	
669	224	4/3/2006	56.1	15	-21.9	-21.9	-78	0	27	38	33	26	26	
670	197	4/3/2006	56.1	15	-21.9	-13.4	-69.5	8.5	23	33	53	93	60-6"	
671	175	4/3/2006	56.1	15	-21.9	-12.9	-69	9	42	33	30	44	103	
672	150	4/3/2006	56.1	15	-21.9	-12.65	-68.75	9.25	63	41	49	67	25-3"	
673	252	4/3/2006	56.1	15	-21.9	-21.9	-78	0	39	41	35	32	25	
674	225	4/3/2006	56.1	15	-21.9	-14.4	-70.5	7.5	22	33	68	79	82	
675	198	4/3/2006	56.1	15	-21.9	-11.9	-68	10	74	52	39	59	83	
676	555	4/3/2006	55.77	35	-32.9	-27.9	-83.67	5	13	17	25	57	72-9"	
677	529	4/3/2006	55.77	35	-32.9	-28.9	-84.67	4	12	16	36	44	74	
678	508	4/3/2006	55.77	35	-32.9	-32.9	-88.67	0	56	46	50	67	31-6"	
679	486	4/3/2006	55.77	35	-32.9	-29.9	-85.67	3	15	18	25	35	65	

TABLE I  
Indicator and Production Pile Summary  
301 Mission Street  
San Francisco, California

Treadwell & Rollé Pile No.	Project Pile Number	Date Driven	Furnished Length (feet)	Predrill Depth (feet)	Design Pile Cutoff Elevation (feet)	Actual Top of Pile Elevation (feet)	Approximate Tip Elevation (feet)	Approximate Cut-off Length (feet)	Final Driving (Blows/foot for final 5 feet)					Remarks
									18	17	17	21	72	
680	556	4/3/2006	55.77	35	-32.9	-27.9	-83.67	5	18	17	17	21	72	
681	530	4/3/2006	55.77	35	-32.9	-27.9	-83.67	5	16	15	16	27	86	
682	509	4/3/2006	55.77	35	-32.9	-29.9	-85.67	3	19	27	60	57	64	
683	487	4/3/2006	55.77	35	-32.9	-29.9	-85.67	3	21	21	34	55	85	
684	461	4/3/2006	55.77	35	-32.9	-28.9	-84.67	4	17	21	24	37	82	
685	435	4/3/2006	55.77	35	-32.9	-30.9	-86.67	2	22	24	26	46	89	
686	436	4/3/2006	55.77	35	-32.9	-18.9	-74.67	14	130	109	117	107	102	
687	176	4/4/2006	56.1	15	-21.9	-11.4	-67.5	10.5	95	55	36	54	48-6"	
688	274	4/4/2006	56.1	15	-21.9	-15.9	-72	6	55	64	69	69	66	
689	253	4/4/2006	56.1	15	-21.9	-13.4	-69.5	8.5	28	25	50	90	106	
690	226	4/4/2006	56.1	15	-21.9	-13.9	-70	8	25	32	70	96	20-3"	
691	199	4/4/2006	56.1	15	-21.9	-14.9	-71	7	49	35	39	80	110	
692	300	4/4/2006	56.1	15	-21.9	-15.7	-71.8	6.2	60	68	51	42	82	
693	275	4/4/2006	56.1	15	-21.9	-13.9	-70	8	31	46	81	92	132	
694	254	4/4/2006	56.1	15	-21.9	-12.9	-69	9	63	30	40	85	94-6"	
695	227	4/4/2006	56.1	15	-21.9	-12.9	-69	9	51	34	43	75	71-6"	
696	322	4/4/2006	56.1	15	-21.9	-11.9	-68	10	52	37	35	50	100-6"	
697	301	4/4/2006	56.1	15	-21.9	-11.4	-67.5	10.5	54	38	34	73	130-10"	
698	276	4/4/2006	56.1	15	-21.9	-12.9	-69	9	51	37	45	80	100-6"	
699	557	4/4/2006	55.77	35	-32.9	-28.9	-84.67	4	16	15	18	36	90	
700	531	4/4/2006	55.77	35	-32.9	-27.9	-83.67	5	17	15	19	22	66	
701	488	4/4/2006	55.77	35	-32.9	-30.9	-86.67	2	22	27	37	56	93	
702	462	4/4/2006	55.77	35	-32.9	-17.9	-73.67	15	127	94	133	100	102	
703	255	4/5/2006	56.1	15	-21.9	-8.5	-64.6	13.4	22	45	86	141	125	
704	323	4/5/2006	56.1	15	-21.9	-11.9	-68	10	52	49	42	50	107	
705	302	4/5/2006	56.1	15	-21.9	-11.9	-68	10	67	41	41	89	60-6"	
706	277	4/5/2006	56.1	15	-21.9	-12.4	-68.5	9.5	71	54	31	49	107	
707	343	4/5/2006	56.1	15	-21.9	-21.9	-78	0	42	37	29	24	26	
708	369	4/5/2006	56.1	15	-21.9	-21.9	-78	0	47	39	33	40	20-6"	
709	344	4/5/2006	56.1	15	-21.9	-21.9	-78	0	5	5	6	8	6	File Broken, no replacement pile needed, see RFI #179
710	370	4/5/2006	56.1	15	-21.9	-12.4	-68.5	9.5	40	32	54	60	40-6"	
711	324	4/5/2006	56.1	15	-21.9	-11.9	-68	10	49	39	39	61	30-3"	
712	345	4/5/2006	56.1	15	-21.9	-11.65	-67.75	10.25	58	41	40	69	20-3"	
713	371	4/5/2006	56.1	15	-21.9	-12.4	-68.5	9.5	47	44	34	44	91	
714	303	4/5/2006	56.1	15	-21.9	-11.15	-67.25	10.75	87	70	44	46	30-3"	
715	325	4/5/2006	56.1	15	-21.9	-21.9	-78	0	7	7	9	11	10	File Broken, no replacement pile needed, see RFI #179
716	346	4/5/2006	56.1	15	-21.9	-10.65	-66.75	11.25	55	51	37	45	20-3"	
717	751	4/5/2006	61.1	35	-21.9	-21.9	-83	0	16	16	21	36	88	
718	752	4/5/2006	61.1	35	-21.9	-21.9	-83	0	11	14	15	25	87	
719	777	4/5/2006	61.1	35	-21.9	-21.9	-83	0	16	19	20	27	61	
720	799	4/5/2006	61.1	35	-21.9	-21.9	-83	0	18	22	30	56	72	
721	778	4/5/2006	61.1	35	-21.9	-21.9	-83	0	17	15	24	56	69-9"	
722	800	4/5/2006	61.1	35	-21.9	-21.9	-83	0	17	19	39	63	27-3"	
723	753	4/5/2006	61.1	35	-21.9	-21.9	-83	0	13	13	12	28	78	

TABLE 1  
Indicator and Production Pile Summary  
301 Mission Street  
San Francisco, California

Treadwell & Rollo Pile No.	Project File Number <sup>1</sup>	Date Driven	Furnished Length (feet) <sup>2</sup>	Predrill Depth (feet)	Design Pile Cutoff Elevation (feet) <sup>3</sup>	Actual Top of Pile Elevation (feet) <sup>3,4</sup>	Approximate Tip Elevation (feet)	Approximate Cut-off Length (feet)	Final Driving (Blows/foot for final 5 feet)	Remarks
724	779	4/5/2006	61.1	35	-21.9	-21.9	-83	0	12 15 22 79 49-3"	
725	801	4/5/2006	61.1	35	-21.9	-21.9	-83	0	15 14 26 42 50-6"	
726	754	4/5/2006	61.1	35	-21.9	-21.9	-83	0	18 18 28 90 47-3"	
727	780	4/5/2006	61.1	35	-21.9	-21.9	-83	0	19 19 30 42 153	
728	802	4/5/2006	61.1	35	-21.9	-21.23	-82.33	0.67	36 30 30 42 85-9"	
729	375	4/6/2006	56.1	15	-21.9	-12.9	-69	9	39 35 33 44 79	
730	398	4/6/2006	56.1	15	-21.9	-21.9	-78	0	33 29 25 22 15	Final blowcount < 21 b/f, capacity is 260 kips - see restrike of pile #393 (3/31/06)
731	397	4/6/2006	56.1	15	-21.9	-21.9	-78	0	33 31 24 25 23	
732	132	4/6/2006	56.1	35	-21.9	-7.5	-63.6	14.4	15 17 39 71 30-3"	
733	133	4/6/2006	56.1	35	-21.9	-7	-63.1	14.9	9 11 30 53 102	
734	396	4/6/2006	56.1	15	-21.9	-21.9	-78	0	40 38 28 29 22	
735	395	4/6/2006	56.1	15	-21.9	-11.4	-67.5	10.5	44 44 42 64 94	
736	418	4/6/2006	46.77	15	-32.9	-23.9	-70.67	9	46 67 74 77 105	
737	419	4/6/2006	46.77	15	-32.9	-20.9	-67.67	12	38 50 59 81 28-3"	
738	417	4/6/2006	46.77	25	-32.9	-19.4	-66.17	13.5	36 43 72 71 126	
739	439	4/6/2006	55.77	25	-32.9	-13.75	-69.52	19.15	69 102 116 165 50-3"	
740	440	4/6/2006	55.77	25	-32.9	-30.9	-86.67	2	20 21 27 46 63	
741	437	4/6/2006	55.77	35	-32.9	-32.9	-88.67	0	13 10 10 9 4-6"	Final blowcount < 21 b/f, capacity is 260 kips - see restrike of pile #393 (3/31/06)
742	438	4/6/2006	55.77	35	-32.9	-30.4	-86.17	2.5	16 18 20 45 65-9"	
743	464	4/6/2006	55.77	35	-32.9	-32.9	-88.67	0	22 39 70 84 90	
744	465	4/6/2006	55.77	35	-32.9	-32.9	-88.67	0	22 52 56 90 30-5"	
745	463	4/6/2006	55.77	35	-32.9	-29.9	-85.67	3	21 22 30 37 61	
746	489	4/6/2006	55.77	35	-32.9	-29.9	-85.67	3	19 28 37 51 70-9"	
747	511	4/6/2006	55.77	35	-32.9	-28.9	-84.67	4	25 26 37 50 61	
748	151	4/7/2006	56.1	25	-21.9	-7.4	-63.5	14.5	20 40 58 93 50-6"	
749	152	4/7/2006	56.1	15	-21.9	-7.4	-63.5	14.5	16 30 45 75 100	
750	177	4/7/2006	56.1	15	-21.9	-6.9	-63	15	24 42 47 85 80-6"	
751	200	4/7/2006	56.1	15	-21.9	-11.4	-67.5	10.5	71 52 45 50 55-6"	
752	228	4/7/2006	56.1	15	-21.9	-11.4	-67.5	10.5	80 57 46 59 45-6"	
753	256	4/7/2006	56.1	15	-21.9	-11.15	-67.25	10.75	52 66 50 49 95	
754	278	4/7/2006	56.1	15	-21.9	-10.65	-66.75	11.25	53 57 65 47 37	
755	304	4/7/2006	56.1	15	-21.9	-11.4	-67.5	10.5	67 86 61 47 50	
756	326	4/7/2006	56.1	15	-21.9	-12.15	-68.25	9.75	54 35 31 43 55-9"	
757	347	4/7/2006	56.1	15	-21.9	-14.2	-70.3	7.7	26 39 74 82 90	
758	178	4/7/2006	56.1	15	-21.9	-11.15	-67.25	10.75	68 61 43 46 20-2"	
759	201	4/7/2006	56.1	15	-21.9	-11.4	-67.5	10.5	86 71 57 48 50-6"	
760	229	4/7/2006	56.1	15	-21.9	-6.9	-63	15	7 15 33 71 130	
761	257	4/7/2006	56.1	15	-21.9	-8.15	-64.25	13.75	32 45 67 72 12-2"	
762	279	4/7/2006	56.1	15	-21.9	-10.65	-66.75	11.25	93 67 43 38 65	
763	532	4/7/2006	55.77	35	-32.9	-30.9	-86.67	2	45 54 37 54 64	
764	558	4/7/2006	55.77	35	-32.9	-27.9	-83.67	5	16 15 22 36 69	
765	654	4/7/2006	61.1	35	-21.9	-21.9	-83	0	13 13 11 51 41-6"	
766	655	4/7/2006	61.1	35	-21.9	-21.9	-83	0	10 11 13 57 38-4"	
767	656	4/7/2006	61.1	35	-21.9	-21.9	-83	0	12 11 13 25 87	

TABLE I  
Indicator and Production Pile Summary  
301 Mission Street  
San Francisco, California

Treadwell & Rollo Pile No.	Project File Number	Date Driven	Furnished Length (feet) <sup>2</sup>	Predrill Depth (feet)	Design Pile Cutoff Elevation (feet) <sup>3</sup>	Actual Top of Pile Elevation (feet) <sup>3,4</sup>	Approximate Tip Elevation (feet) <sup>3</sup>	Approximate Cut-off Length (feet)	Final Driving (Blows/foot for final 5 feet)					Remarks
768	657	4/7/2006	61.1	35	-21.9	-21.9	-83	0	12	10	15	22	100	
769	628	4/7/2006	51.77	35	-32.9	-31.9	-83.67	1	13	12	17	35	95	
770	607	4/7/2006	51.77	35	-32.9	-30.9	-82.67	2	15	15	16	27	60-6"	
771	585	4/7/2006	51.77	35	-32.9	-32.9	-84.67	0	19	15	16	42	88	
772	629	4/7/2006	51.77	35	-32.9	-30.9	-82.67	2	12	16	17	54	63-6"	
773	608	4/7/2006	51.77	35	-32.9	-30.9	-82.67	2	16	16	20	25	94	
774	305	4/8/2006	56.1	15	-21.9	-21.9	-78	0	8	7	10	8	12	Pile Broken, no replacement pile needed, see RFI #182
775	327	4/8/2006	56.1	15	-21.9	-8.4	-64.5	13.5	5	17	43	55	67	
776	348	4/8/2006	56.1	15	-21.9	-12.4	-68.5	9.5	38	26	23	37	69	
777	374	4/8/2006	56.1	15	-21.9	-12.4	-68.5	9.5	32	26	19	44	77	
778	153	4/8/2006	56.1	15	-21.9	-6.9	-63	15	23	25	39	66	99	
779	179	4/8/2006	56.1	15	-21.9	-6.9	-63	15	11	26	34	60	90	
780	202	4/8/2006	56.1	15	-21.9	-11.65	-67.75	10.25	69	47	31	35	40-6"	
781	230	4/8/2006	56.1	15	-21.9	-7.4	-63.5	14.5	8	12	37	67	42-6"	
782	258	4/8/2006	56.1	15	-21.9	-7.65	-63.75	14.25	12	18	35	53	70	
783	280	4/8/2006	56.1	15	-21.9	-6.75	-62.85	15.15	6	7	11	41	80	
784	306	4/8/2006	56.1	15	-21.9	-6.9	-63	15	6	11	30	70	55-6"	
785	328	4/8/2006	56.1	15	-21.9	-11.65	-67.75	10.25	51	26	19	39	42-6"	
786	349	4/8/2006	56.1	15	-21.9	-13.15	-69.25	8.75	19	17	27	52	80	
787	375	4/8/2006	56.1	15	-21.9	-13.4	-69.5	8.5	13	14	32	50	67	
788	159	4/8/2006	56.1	15	-21.9	-6.5	-62.6	15.4	12	32	48	45	98	
789	203	4/8/2006	56.1	15	-21.9	-6.9	-63	15	19	17	32	56	80	
790	204	4/8/2006	56.1	15	-21.9	-11	-67.1	10.9	62	61	54	41	40-6"	
791	232	4/8/2006	56.1	15	-21.9	-7.9	-64	14	18	19	35	57	75	
792	259	4/8/2006	56.1	15	-21.9	-7.9	-64	14	10	20	42	72	77	
793	586	4/8/2006	51.77	35	-32.9	-32.9	-84.67	0	15	18	39	44	35	
794	630	4/8/2006	51.77	35	-32.9	-31.9	-83.67	1	14	16	21	55	63-6"	
795	609	4/8/2006	51.77	35	-32.9	-31.9	-83.67	1	16	14	16	22	84	
796	587	4/8/2006	51.77	35	-32.9	-32.9	-84.67	0	19	25	48	58	20-6"	
797	559	4/8/2006	55.77	35	-32.9	-28.4	-84.17	4.5	20	18	19	50	89	
798	533	4/8/2006	55.77	35	-32.9	-29.4	-85.17	3.5	15	17	29	49	85	
799	512	4/8/2006	55.77	35	-32.9	-29.9	-85.67	3	21	20	26	40	76	
800	490	4/8/2006	55.77	35	-32.9	-14	-69.77	18.9	59	78	117	168	78-4"	
801	560	4/8/2006	55.77	35	-32.9	-16	-71.77	16.9	50	110	129	170	209	
802	534	4/8/2006	55.77	35	-32.9	-16	-71.77	16.9	63	84	110	134	154	
803	513	4/8/2006	55.77	35	-32.9	-14.5	-70.27	18.4	32	76	96	150	100-6"	
804	260	4/10/2006	56.1	15	-21.9	-7.5	-63.6	14.4	7	12	20	34	72	
805	286	4/10/2006	56.1	15	-21.9	-7.75	-63.85	14.15	4	22	44	72	85	
806	329	4/10/2006	56.1	15	-21.9	-13.9	-70	8	18	22	46	67	75	
807	355	4/10/2006	56.1	15	-21.9	-13.9	-70	8	15	22	48	74	74	
808	399	4/10/2006	56.1	15	-21.9	-21.9	-78	0	36	32	23	21	21	
809	421	4/10/2006	56.1	15	-21.9	-21.9	-78	0	47	38	30	30	24	
810	420	4/10/2006	56.1	15	-21.9	-12.65	-68.75	9.25	34	28	48	70	86	
811	400	4/10/2006	56.1	15	-21.9	-12.65	-68.75	9.25	32	28	36	54	88	

TABLE 1  
Indicator and Production Pile Summary  
301 Mission Street  
San Francisco, California

Treadwell & Kelle Pile No.	Project Pile Number	Date Driven	Furnished Length (feet) <sup>2</sup>	Pre-drill Depth (feet)	Design Pile Cutoff Elevation (feet) <sup>3</sup>	Actual Top of Pile Elevation (feet) <sup>3,*</sup>	Approximate Tip Elevation (feet) <sup>3</sup>	Approximate Cut-off Length (feet)	Final Driving (Blows/foot for final 5 feet)	Remarks
812	401	4/10/2006	56.1	15	-21.9	-13.4	-69.5	8.5	19 25 49 63 82	
813	422	4/10/2006	56.1	15	-21.9	-12.65	-68.75	9.25	28 23 32 56 87	
814	423	4/10/2006	56.1	15	-21.9	-13.15	-69.25	8.75	17 18 33 73 82	
815	828	4/10/2006	61.1	35	-21.9	-21.9	-83	0	14 14 23 48 55	
816	829	4/10/2006	61.1	35	-21.9	-21.9	-83	0	12 13 26 39 49-6"	
817	803	4/10/2006	61.1	35	-21.9	-21.9	-83	0	12 14 21 51 24-4"	
818	781	4/10/2006	61.1	35	-21.9	-21.9	-83	0	11 11 15 50 30-6"	
819	755	4/10/2006	61.1	35	-21.9	-21.9	-83	0	13 15 20 50 40-6"	
820	733	4/10/2006	61.1	35	-21.9	-21.9	-83	0	17 17 20 28 37-6"	
821	705	4/10/2006	61.1	35	-21.9	-21.9	-83	0	12 15 19 79 70-6"	
822	677	4/10/2006	61.1	35	-21.9	-21.9	-83	0	18 19 21 34 70-6"	
823	678	4/10/2006	61.1	35	-21.9	-21.9	-83	0	17 15 17 34 50-6"	
824	706	4/10/2006	61.1	35	-21.9	-21.9	-83	0	21 20 19 25 130	
825	734	4/10/2006	61.1	35	-21.9	-12.9	-74	9	43 55 74 71 85	
826	756	4/10/2006	61.1	35	-21.9	-21.9	-83	0	15 14 28 56 100-9"	
827	782	4/10/2006	61.1	35	-21.9	-21.9	-83	0	15 15 14 21 83-10"	
828	804	4/13/2006	61.1	30	-21.9	-21.9	-83	0	14 15 22 61 17-3"	
829	805	4/13/2006	61.1	30	-21.9	-21.9	-83	0	15 17 30 66 25-3"	
830	783	4/13/2006	61.1	30	-21.9	-21.9	-83	0	15 16 18 37 32-6"	
831	757	4/13/2006	61.1	30	-21.9	-21.9	-83	0	23 20 18 27 65	
832	735	4/13/2006	61.1	30	-21.9	-11.9	-73	10	34 47 56 66 55-10"	
833	707	4/13/2006	61.1	25	-21.9	-9.9	-71	12	18 24 41 57 85	
834	679	4/13/2006	61.1	25	-21.9	-10.4	-71.5	11.5	26 45 53 58 82	
835	561	4/13/2006	55.77	30	-32.9	-32.9	-88.67	0	37 10 6 8 6	Pile Broken, no replacement pile needed, see RFI #203
836	535	4/13/2006	55.77	30	-32.9	-29.9	-85.67	3	22 26 30 42 70	
837	514	4/13/2006	55.77	30	-32.9	-21.9	-77.67	11	76 66 86 71 101	
838	681	4/14/2006	61.1	30	-21.9	-21.9	-83	0	11 13 12 34 34-9"	
839	709	4/14/2006	61.1	25	-21.9	-21.9	-83	0	13 14 14 35 56-9"	
840	737	4/14/2006	61.1	25	-21.9	-21.9	-83	0	13 17 25 70 13-3"	
841	682	4/14/2006	61.1	30	-21.9	-21.9	-83	0	17 19 17 30 78	
842	710	4/14/2006	61.1	30	-21.9	-21.9	-83	0	23 17 19 37 75	
843	738	4/14/2006	61.1	30	-21.9	-21.9	-83	0	13 14 20 63 38-6"	
844	683	4/14/2006	61.1	30	-21.9	-21.9	-83	0	21 18 22 65 70-9"	
845	711	4/14/2006	61.1	30	-21.9	-21.9	-83	0	18 17 20 44 66-6"	
846	739	4/14/2006	61.1	30	-21.9	-9.9	-71	12	26 43 57 72 102	
847	761	4/14/2006	61.1	30	-21.9	-21.9	-83	0	13 12 20 41 65	
848	760	4/14/2006	61.1	30	-21.9	-21.9	-83	0	17 17 22 33 93	
849	491	4/15/2006	55.77	30	-32.9	-15.9	-71.67	17	67 81 102 85 100	
850	492	4/15/2006	55.77	30	-32.9	-30.9	-86.67	2	7 7 6 3 3	Pile Broken, no replacement pile needed, see RFI #203
851	466	4/15/2006	55.77	30	-32.9	-13	-68.77	19.9	26 54 68 77 106	
852	441	4/15/2006	65.1	30	-21.9	-3	-68.1	18.9	38 42 61 110 130	
853	381	4/15/2006	56.1	30	-21.9	-21.9	-78	0	31 25 23 18 19	Final blowcount < 21 b/f, capacity is 260 kips - see restrike of pile #393 (3/31/06)
854	424	4/15/2006	56.1	30	-21.9	-14.9	-71	7	16 32 49 72 78	
855	467	4/17/2006	65.1	30	-21.9	-3	-68.1	18.9	27 34 36 75 90	



TABLE 1  
Indicator and Production Pile Summary  
301 Mission Street  
San Francisco, California

Treadwell & Rollo Pile No.	Project Pile Number	Date Driven	Furnished Length (feet) <sup>2</sup>	Predrill Depth (feet)	Design Pile Cutoff Elevation (feet) <sup>3</sup>	Actual Top of Pile Elevation (feet) <sup>3,4</sup>	Approximate Tip Elevation (feet) <sup>3</sup>	Approximate Cut-off Length (feet)	Final Driving (Blows/foot for final 5 feet)					Remarks
856	493	4/17/2006	65.1	30	-21.9	-18.2	-83.3	3.7	30	30	41	85	105	
857	442	4/17/2006	61.1	30	-21.9	-3.5	-64.6	18.4	30	26	46	90	98	
858	468	4/17/2006	61.1	25	-21.9	-3.9	-65	18	28	28	52	91	89	
859	494	4/17/2006	61.1	35	-21.9	-5.7	-66.8	16.2	32	55	67	78	93	
860	443	4/17/2006	61.1	30	-21.9	-3	-64.1	18.9	24	22	31	71	95	
861	469	4/17/2006	61.1	30	-21.9	-4	-65.1	17.9	29	43	68	75	64-6"	
862	495	4/17/2006	61.1	30	-21.9	-4	-65.1	17.9	20	29	53	81	94	
863	444	4/17/2006	61.1	30	-21.9	-5	-66.1	16.9	18	34	68	72	92	
864	470	4/17/2006	61.1	30	-21.9	-4.3	-65.4	17.6	11	23	51	73	103	
865	496	4/17/2006	61.1	30	-21.9	-21.9	-83	0	12	11	16	15	10-6"	
866	135-R	4/17/2006	56.1	25	-21.9	-6.9	-63	15	11	18	33	73	95	Replacement pile for pile #135 broken during driving on 3/22/06
867	450	4/17/2006	65.1	30	-21.9	-4.3	-69.4	17.6	24	37	61	73	98	
868	476	4/17/2006	65.1	30	-21.9	-20.9	-86	1	18	18	20	44	60	
869	515	4/18/2006	65.1	0	-21.9	-4.2	-69.3	17.7	20	37	62	77	95	
870	536	4/18/2006	65.1	0	-21.9	-21.9	-87	0	15	15	10	6	12	Final blowcount < 21 b/ft, capacity is 260 kips - see restrike of pile #393 (3/31/06)
871	562	4/18/2006	65.1	25	-21.9	-21.9	-87	0	19	29	50	65	12-3"	
872	588	4/18/2006	61.1	25	-21.9	-21.9	-83	0	15	15	14	17	7-4"	
873	516	4/18/2006	65.1	0	-21.9	-4.5	-69.6	17.4	20	42	70	62	82	
874	537	4/18/2006	65.1	0	-21.9	-4	-69.1	17.9	18	33	68	81	100	
875	563	4/18/2006	65.1	0	-21.9	-5	-70.1	16.9	41	68	65	74	85	
876	589	4/18/2006	61.1	0	-21.9	-4	-65.1	17.9	62	58	73	67	64	
877	517	4/18/2006	65.1	0	-21.9	-3	-68.1	18.9	21	20	28	86	122	
878	538	4/18/2006	65.1	0	-21.9	-6.5	-71.6	15.4	42	64	67	73	86	
879	564	4/18/2006	65.1	0	-21.9	-4	-69.1	17.9	34	44	68	81	85	
880	590	4/18/2006	61.1	0	-21.9	-10	-71.1	11.9	57	53	57	68	73	
881	518	4/18/2006	65.1	25	-21.9	-4.5	-69.6	17.4	16	39	54	73	85	
882	539	4/18/2006	65.1	0	-21.9	-3.2	-68.3	18.7	19	21	46	76	90	
883	610	4/19/2006	61.1	0	-21.9	-21.9	-83	0	18	16	15	20	49	
884	631	4/19/2006	61.1	20	-21.9	-9.9	-71	12	33	52	58	63	73	
885	680	4/19/2006	61.1	20	-21.9	-21.9	-83	0	19	15	18	32	61	
886	611	4/19/2006	61.1	0	-21.9	-8	-69.1	13.9	27	42	45	72	83	
887	632	4/19/2006	61.1	0	-21.9	-7	-68.1	14.9	18	35	49	70	103	
888	658	4/19/2006	61.1	0	-21.9	-7.2	-68.3	14.7	18	29	47	74	110	
889	612	4/19/2006	61.1	0	-21.9	-7	-68.1	14.9	21	35	51	86	88	
890	633	4/19/2006	61.1	0	-21.9	-6	-67.1	15.9	18	41	67	94	62-6"	
891	519	4/19/2006	65.1	0	-21.9	-5.5	-70.6	16.4	36	51	58	77	92	
892	565	4/19/2006	65.1	0	-21.9	-7	-72.1	14.9	64	57	70	72	68	
893	591	4/19/2006	61.1	0	-21.9	-7	-68.1	14.9	22	36	45	77	109	
894	613	4/19/2006	61.1	0	-21.9	-5.7	-66.8	16.2	13	29	47	73	125	
895	634	4/19/2006	61.1	0	-21.9	-7	-68.1	14.9	22	37	52	75	86	
896	660	4/19/2006	61.1	0	-21.9	-8	-69.1	13.9	36	48	65	82	110	
897	708	4/20/2006	61.1	0	-21.9	-14.5	-75.6	7.4	86	68	57	52	15-4"	
898	736	4/20/2006	61.1	0	-21.9	-10.5	-71.6	11.4	29	46	56	75	100	
899	877-R	4/20/2006	65.1	30	-21.9	-17.9	-83	4	14	14	19	42	68	Replacement pile for pile #877 broken during driving on 3/23/06

TABLE 1  
Indicator and Production Pile Summary  
301 Mission Street  
San Francisco, California

Treadwell & Rolfe Pile No.	Project Pile Number	Date Driven	Furnished Length (feet)	Pre-drill Depth (feet)	Design Pile Cutoff Elevation (feet)	Actual Top of Pile Elevation (feet)	Approximate Tip Elevation (feet)	Approximate Cut-off Length (feet)	Final Driving (Blows/foot for final 5 feet)					Remarks
									19	18	22	56	39-4"	
900	758	4/20/2006	61.1	0	-21.9	-21.9	-83	0	19	18	22	56	39-4"	
901	784	4/21/2006	61.1	0	-21.9	-21.9	-83	0	21	17	20	34	92	
902	806	4/21/2006	61.1	0	-21.9	-21.9	-83	0	16	15	18	39	74	
903	759	4/21/2006	61.1	0	-21.9	-12	-73.1	9.9	43	54	66	56	73	
904	785	4/21/2006	61.1	0	-21.9	-12	-73.1	9.9	32	33	48	57	69	
905	807	4/21/2006	61.1	0	-21.9	-12	-73.1	9.9	28	34	42	55	76	
906	830	4/21/2006	61.1	15	-21.9	-21.9	-83	0	15	16	20	61	75	
907	786	4/21/2006	61.1	0	-21.9	-10	-71.1	11.9	19	22	44	58	90	
908	808	4/21/2006	61.1	0	-21.9	-21.9	-83	0	22	20	25	57	105	
909	787	4/21/2006	61.1	0	-21.9	-21.9	-83	0	20	20	27	57	76	
910	809	4/21/2006	61.1	0	-21.9	-11.5	-72.6	10.4	27	41	58	57	65	
911	767	4/21/2006	61.1	3	-21.9	-11	-72.1	10.9	21	38	52	58	69	
912	545	4/21/2006	65.1	0	-21.9	-21.9	-87	0	18	18	38	51	60	
913	571	4/21/2006	61.1	0	-21.9	-8	-69.1	13.9	24	24	46	73	88	
914	614	4/21/2006	61.1	0	-21.9	-21.9	-83	0	21	18	17	10	30	
915	640	4/22/2006	61.6	0	-21.9	-9	-70.6	12.9	42	51	60	73	75	
916	684	4/22/2006	61.1	0	-21.9	-9	-70.1	12.9	37	52	51	77	83	
917	712	4/22/2006	61.1	0	-21.9	-9	-70.1	12.9	20	37	55	72	78	
918	740	4/22/2006	61.1	0	-21.9	-9	-70.1	12.9	14	17	40	59	70	
919	546	4/22/2006	65.1	30	-21.9	-21.9	-87	0	15	19	30	47	60	
920	685	4/22/2006	61.1	30	-21.9	-8	-69.1	13.9	22	25	48	58	83	
921	713	4/22/2006	61.1	30	-21.9	-8	-69.1	13.9	26	24	48	87	60-6"	
922	741	4/22/2006	61.1	30	-21.9	-9	-70.1	12.9	18	21	40	65	96	

1. Pile Location as designated on drawing titled "Martin Ron Pile Numbering Diagram as transmitted electronically to us by WEBCOR Building on 11 November 2005.
2. Casted pile length
3. All Elevations refer to San Francisco City datum (SFCD).
4. Recorded visually, accuracy may vary by +/- 6 inches
5. DNO denotes Did Not Observe

Total number of piles requiring cutoff:	381	40%
Number of piles requiring more than 5 feet of cutoff:	238	25%
Number of piles requiring more than 12 feet of cutoff:	80	8%
Number of piles requiring more than 15 feet of cutoff:	34	4%
Number of piles that broke during installation:	9	1%
Number of replacement piles driven:	2	0.2%